



TRANSLAS [®]
DUTCH TORCH TECHNOLOGY

MIG TORCHES

CAPABILITY DEFINED





ABOUT TRANSLAS

Translas is a Dutch manufacturer of welding guns since 1960. A company founded by welders, for welders with a passion for innovation and new technologies, continually strives to engineer innovative products that boast a distinctive design, quality, and functionality.

Welder's safety is of paramount importance to Translas. The company's goal is to globally reduce welders' exposure to hazardous fumes and provide a healthier and safer work environment. Some of the pioneering products include extractor guns with a built-in module to safely extract welding fumes at the source and portable extraction units for high-performance extraction.

www.translas.com

TABLE OF CONTENTS

Reliable, high-range torch offers the best price/quality ratio.

ABOUT TRANSLAS	2
8XM TORCHES	5
CONTACT TIPS / TIPADAPTERS	48
LINERS	50
NOZZLES	52
MACHINE CONNECTIONS	54
EART CLAMPS - CABLE CONNECTORS	55
ELECTRODE HOLDERS - ANT-SPATTER	56
MIG PLIERS AND OTHER TOOLS	57

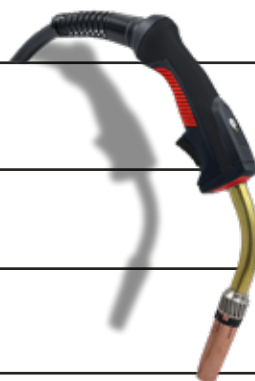

MIG Catalogue

Scan the QR code with your smart phone





TRANSLAS MIG TORCHES

The MIG torches of Translas are of no ordinary quality. These reliable, high-range torches offer the Best Price/Quality ratio. Other benefits of the Translas MIG torches are the welding comfort provided and the smart get-up.

TRANSLAS [®]
DUTCH TORCH TECHNOLOGY

8XM MIG TORCH

STRENGTH AND CAPABILITY





8XM MIG TORCHES



MIG
TORCHES



MIG 8XM

**Oval Shaped Handle For Optimal Grip.
Smooth Revolving Cable Support.**

THE CONCEPT

The new 8XM torches from Translas are high-end MIG/MAG welding torches covering every need of the welder. The 8XM offers excellent comfort and long durability. Welders can now trust their torch 100%.

GENERAL

Every detail in the torches makes welding work even more comfortable and more enjoyable. The handle of the new 8XM has a strong and solid construction, is light in weight and easy to (dis)assemble.

HEAVY DUTY



8XM MIG TORCHES

**MIG
TORCHES**



WIDER SWITCH

The switch on an 8XM torch is 30% wider than standard switches and, therefore, is more comfortable to click on. It also has a long-distance microswitch which makes the click more tangible.

RIBBED BOTTOM CAP

With the use of 2k rubber inlay, the bottom cap of the handle is made with ribs. The ribs and the TPE rubber provide optimal grip on the torch and make for a unique design.

NEW BACK HOUSING

The 8XM torches are provided with new and improved back housing, with more grip.



COMFORTABLE



8XM MIG TORCHES LINE

MIG
8XM



8XM MIG TORCH
8XM 15 AIR COOLED

CO2 - 180 AMP
Mixed Gases - 150 AMP
Duty Cycle - 60%



8XM MIG TORCH
8XM 15SN AIR COOLED

CO2 - 180 AMP
Mixed Gases - 150 AMP
Duty Cycle - 60%



8XM MIG TORCH
8XM 24 AIR COOLED

CO2 - 250 AMP
Mixed Gases - 220 AMP
Duty Cycle - 60%



8XM MIG TORCH
8XM 25 AIR COOLED

CO2 - 230 AMP
Mixed Gases - 200 AMP
Duty Cycle - 60%



8XM MIG TORCHES LINE



8XM MIG TORCH
8XM 25SN AIR COOLED
CO2 - 230 AMP
Mixed Gases - 200 AMP
Duty Cycle - 60%



8XM MIG TORCH
8XM 26 AIR COOLED
CO2 - 230 AMP
Mixed Gases - 200 AMP
Duty Cycle - 60%



8XM MIG TORCH
8XM 36 AIR COOLED
CO2 - 320 AMP
Mixed Gases - 300 AMP
Duty Cycle - 60%



8XM MIG TORCH
8XM 36SN AIR COOLED
CO2 - 330 AMP
Mixed Gases - 300 AMP
Duty Cycle - 60%



8XM MIG TORCHES LINE

MIG
8XM



8XM MIG TORCH

8XM
38 AIR
COOLED

CO2 - 350 AMP
Mixed Gases - 320 AMP
Duty Cycle - 60%



8XM MIG TORCH

8XM
40 AIR
COOLED

CO2 - 400 AMP
Mixed Gases - 380 AMP
Duty Cycle - 60%



8XM MIG TORCH

8XM
240 WATER
COOLED

CO2 - 300 AMP
Mixed Gases - 270 AMP
Duty Cycle - 100%



8XM MIG TORCH

8XM
352 WATER
COOLED

CO2 - 360 AMP
Mixed Gases - 340 AMP
Duty Cycle - 100%



8XM MIG TORCHES LINE



8XM MIG TORCH
8XM 410 WATER COOLED

CO2 - 500 AMP
Mixed Gases - 450 AMP
Duty Cycle - 100%



8XM MIG TORCH
8XM 410SN WATER COOLED

CO2 - 500 AMP
Mixed Gases - 450 AMP
Duty Cycle - 100%



8XM MIG TORCH
8XM 450/550 WATER COOLED

CO2 - 550 AMP
Mixed Gases - 500 AMP
Duty Cycle - 100%



8XM MIG TORCH
8XM 510 WATER COOLED

CO2 - 550 AMP
Mixed Gases - 500 AMP
Duty Cycle - 100%



8XM - 15 MIG TORCH

CO2 - 180 AMP, MIXED GASES - 150 AMP, DUTY CYCLE - 60%



AIR COOLED

HEAVY DUTY

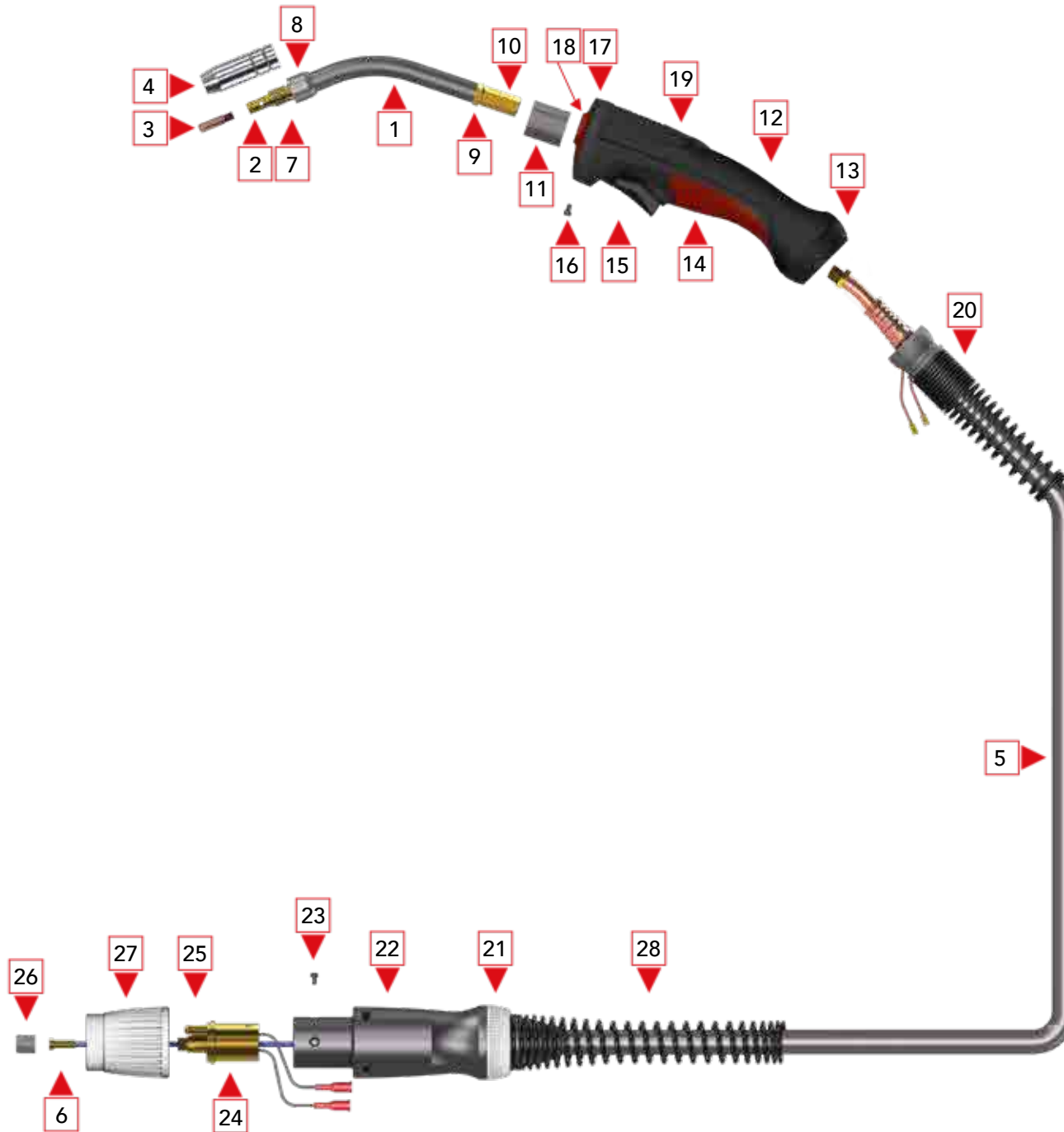

ITEM	PART NO.	DESCRIPTION	PACK QTY
COMPLETE TORCHES			
-	8M01500100300	8XM-15 MIG torch 3mtr	1
-	8M01500100400	8XM-15 MIG torch 4mtr	1
-	8M01500100500	8XM-15 MIG torch 5mtr	1

ITEM	PART NO.	DESCRIPTION	PACK QTY
SPARE PARTS			
1	300030	Swanneck	1
2	150000	Tipadaptor M6	10
3	100102	Contacttip M6-06-0.8mm	100
		Other contacttips, see: Options and wear parts	Page 48
4	200120	Nozzle conical	10
		Other nozzles, see: Options and wear parts	Page 52
5	258153	Cable assembly 16mm ² 3mtr	1
	258154	Cable assembly 16mm ² 4mtr	1
	258155	Cable assembly 16mm ² 5mtr	1
6	301535	P.C. liner blue (ø 1,5/4,5mm round) 3mtr	1
	301545	P.C. liner blue (ø 1,5/4,5mm round) 4mtr	1
	301555	P.C. liner blue (ø 1,5/4,5mm round) 5mtr	1
		Other liners, see: Options and wear parts	Page 50
7	305600	Nozzle spring	10
8	305241	Insulator	5
9	305401	Lock nut M10x1x5mm	10
10	305400	Hexagonal fitting M10x1x26mm	10
11	305500	Plastic body	5



ITEM	PART NO.	DESCRIPTION	PACK QTY
SPARE PARTS			
12	8M9918	8XM Handle complete 16mm	1
13	8M9300	8XM Locking nut	1
14	8M9154	8XM Bottom cap standard	1
15	8M9352	8XM Trigger	1
	361192	8XM Spring for switch	5
	8M8900	8XM Micro switch	1
16	501151	Screw	25
17	8M9200	8XM Locking cap	1
18	8M9254	8XM Swanneck adapter 16mm	1
19	8M9100	8XM Blind cap	1
20	8M9601	Cable support	1
21	8M9419	8XM Locking ring	1
22	8M9400	8XM Housing for central connector	1
23	305310	Screw M4 X 6	25
24	305298	Central connector Euro with spring pin	1
25	305309	Spring pin complete	10
26	305316	Liner positioner nut	10
27	8M9420	8XM Adaptor nut	1
28	8M9500	Cable support spring	1

COMFORTABLE



8XM - 15SN MIG TORCH

CO2 - 180 AMP, MIXED GASES - 150 AMP, DUTY CYCLE - 60%



AIR COOLED

HEAVY DUTY

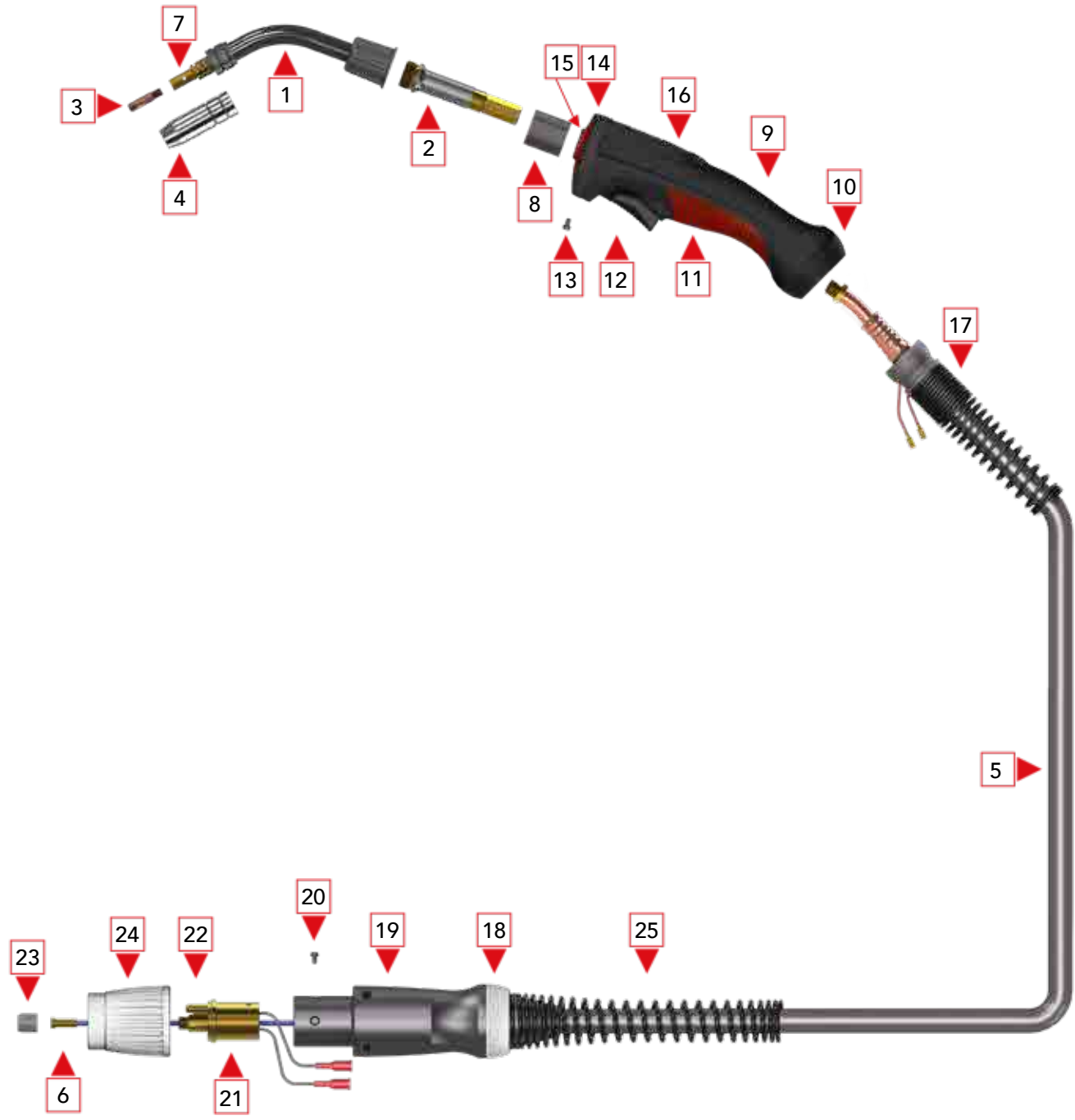

ITEM	PART NO.	DESCRIPTION	PACK QTY
COMPLETE TORCHES			
-	8M01700100300	8XM-15SN MIG torch 3mtr	1
-	8M01700100400	8XM-15SN MIG torch 4mtr	1
-	8M01700100500	8XM-15SN MIG torch 5mtr	1

ITEM	PART NO.	DESCRIPTION	PACK QTY
SPARE PARTS			
1	300400	SN Swanneck	1
2	204070	SN Connection part	1
3	100102	Contacttip M6-06-0.8mm	100
		Other contacttips, see: Options and wear parts	Page 48
4	200120	Nozzle conical	10
		Other nozzles, see: Options and wear parts	Page 52
5	258153	Cable assembly 16mm ² 3mtr	1
	258154	Cable assembly 16mm ² 4mtr	1
	258155	Cable assembly 16mm ² 5mtr	1
6	301535	P.C. liner blue (ø 1,5/4,5mm round) 3mtr	1
	301545	P.C. liner blue (ø 1,5/4,5mm round) 4mtr	1
	301555	P.C. liner blue (ø 1,5/4,5mm round) 5mtr	1
		Other liners, see: Options and wear parts	Page 50
7	305600	Nozzle spring	10
8	305500	Plastic body	5
9	8M9918	8XM Handle complete 16mm	10
10	8M9300	8XM Locking nut	10
11	8M9154	8XM Bottom cap standard	5



ITEM	PART NO.	DESCRIPTION	PACK QTY
SPARE PARTS			
12	8M9352	8XM Trigger	1
	361192	8XM Spring for switch	5
	8M8900	8XM Micro switch	1
13	501151	Screw	25
14	8M9200	8XM Locking cap	1
15	8M9254	8XM Swanneck adapter 16mm	1
16	8M9100	8XM Blind cap	1
17	8M9601	Cable support	1
18	8M9419	8XM Locking ring	1
19	8M9400	8XM Housing for central connector	1
20	305310	Screw M4 X 6	25
21	305298	Central connector Euro with spring pin	1
22	305309	Spring pin complete	10
23	305316	Liner positioner nut	10
24	8M9420	8XM Adaptor nut	1
25	8M9500	Cable support spring	1

COMFORTABLE



8XM - 24 MIG TORCH

CO2 - 250 AMP, MIXED GASES - 220 AMP, DUTY CYCLE - 60%



AIR COOLED

HEAVY DUTY

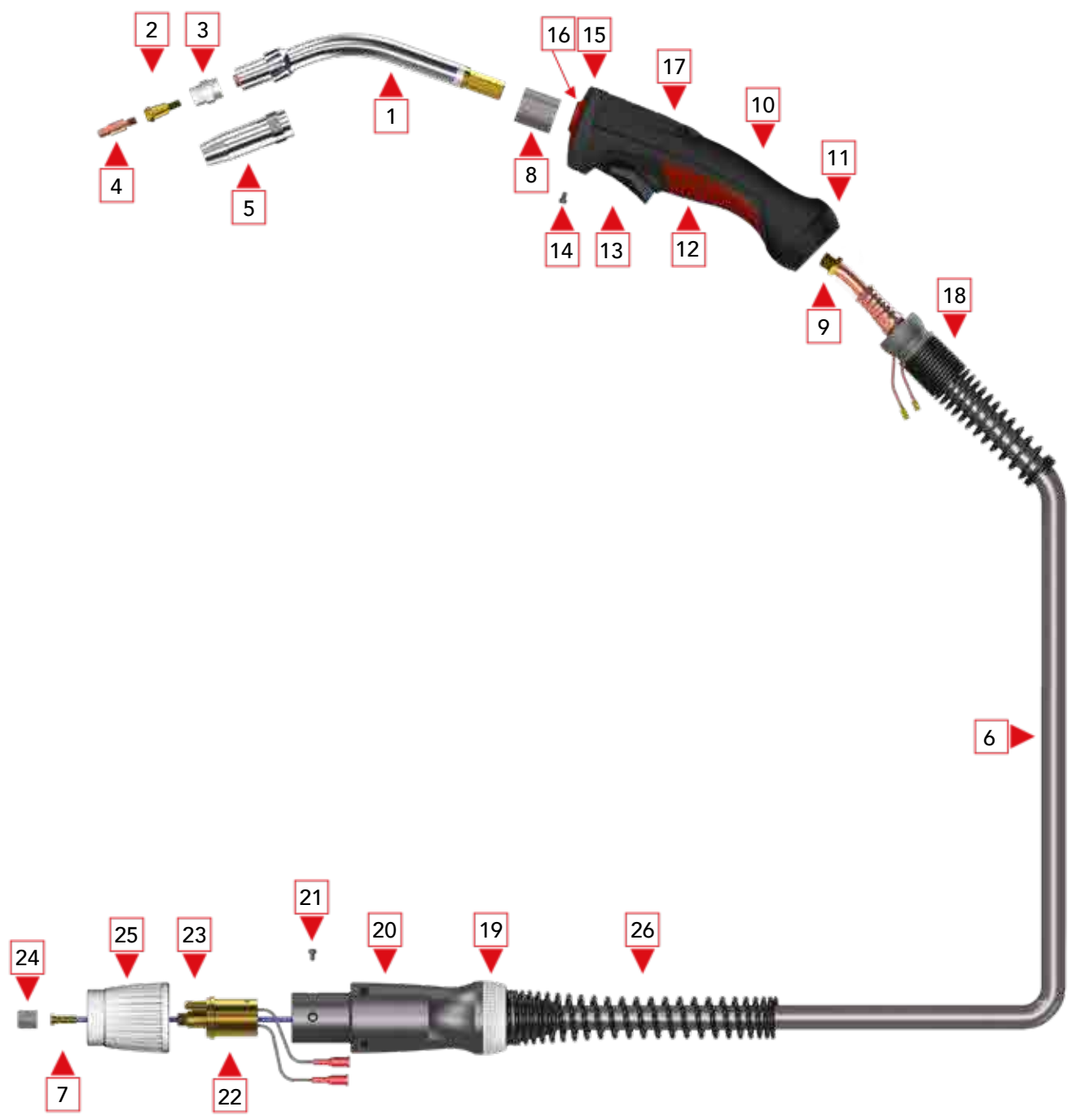

ITEM	PART NO.	DESCRIPTION	PACK QTY
COMPLETE TORCHES			
-	8M02400100300	8XM-24 MIG torch 3mtr	1
-	8M02400100400	8XM-24 MIG torch 4mtr	1
-	8M02400100500	8XM-24 MIG torch 5mtr	1

ITEM	PART NO.	DESCRIPTION	PACK QTY
SPARE PARTS			
1	300624	Swanneck	1
2	150002	Tipadaptor M6	10
3	300510	Diffuser white	25
4	100206	Contacttip M6-08-1,0mm	100
		Other contacttips, see: Options and wear parts	Page 48
5	200300	Nozzle conical	10
		Other nozzles, see: Options and wear parts	Page 52
6	258253	Cable assembly 25mm ² 3mtr	1
	258254	Cable assembly 25mm ² 4mtr	1
	258255	Cable assembly 25mm ² 5mtr	1
7	302535	P.C. liner red (ø 2,0/4,5mm round) 3mtr	1
	302545	P.C. liner red (ø 2,0/4,5mm round) 4mtr	1
	302555	P.C. liner red (ø 2,0/4,5mm round) 5mtr	1
		Other liners, see: Options and wear parts	Page 50
8	305500	Plastic body	5
9	305401	Lock nut M10x1x5mm	10
10	8M9918	8XM Handle complete 16mm	1
11	8M9300	8XM Locking nut	1
12	8M9154	8XM Bottom cap standard	1



ITEM	PART NO.	DESCRIPTION	PACK QTY
SPARE PARTS			
13	8M9352	8XM Trigger	1
	361192	8XM Spring for switch	5
	8M8900	8XM Micro switch	1
14	501151	Screw	25
15	8M9200	8XM Locking cap	1
16	8M9254	8XM Swanneck adapter 16mm	1
17	8M9100	8XM Blind cap	1
18	8M9601	Cable support	1
19	8M9419	8XM Locking ring	1
20	8M9400	8XM Housing for central connector	1
21	305310	Screw M4 X 6	25
22	305298	Central connector Euro with spring pin	1
23	305309	Spring pin complete	10
24	305316	Liner positioner nut	10
25	8M9420	8XM Adaptor nut	1
26	8M9500	Cable support spring	1

COMFORTABLE



8XM - 25 MIG TORCH

CO2 - 230 AMP, MIXED GASES - 200 AMP, DUTY CYCLE - 60%



AIR COOLED

HEAVY DUTY

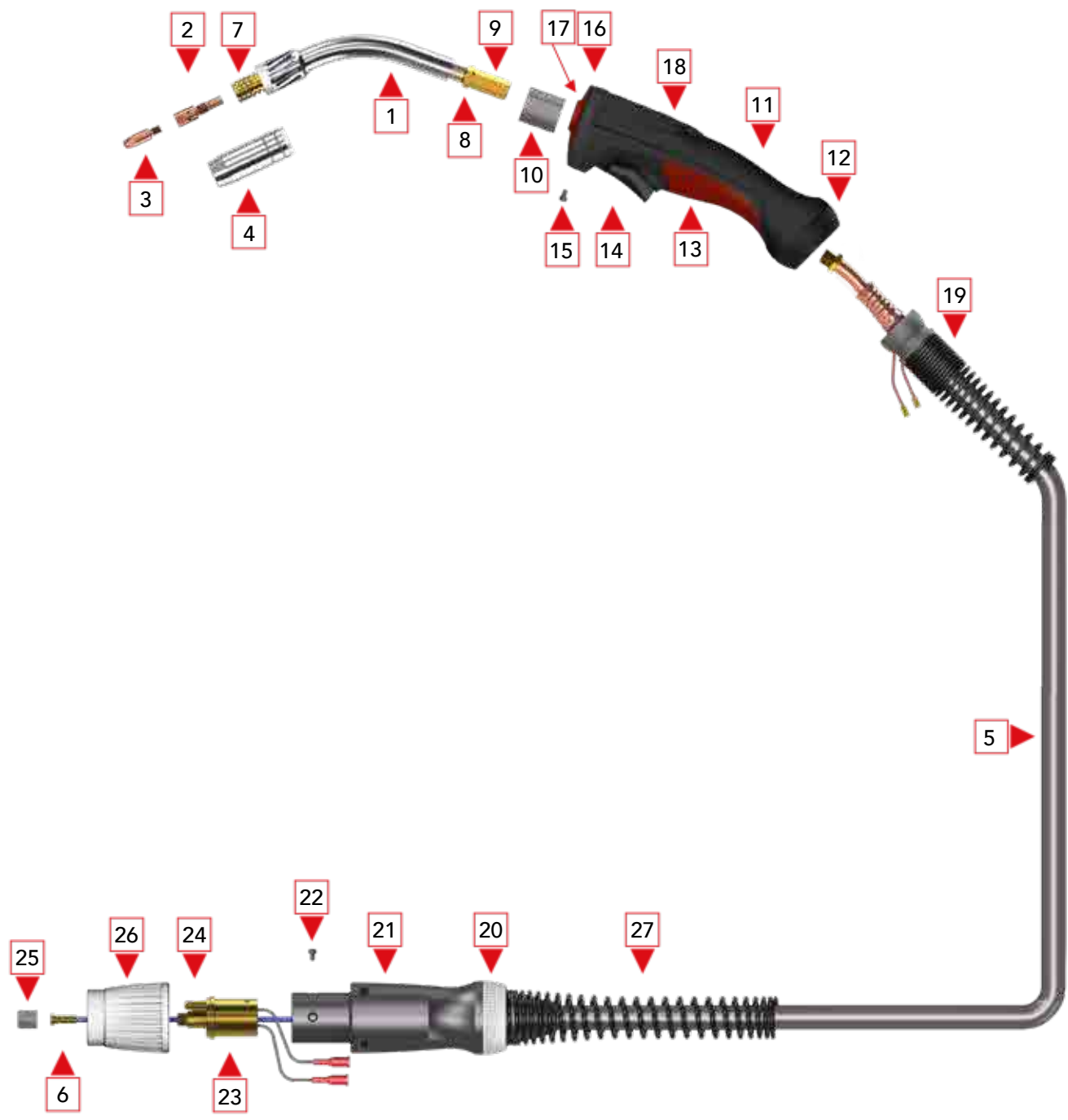

ITEM	PART NO.	DESCRIPTION	PACK QTY
COMPLETE TORCHES			
-	8M02500100300	8XM-25 MIG torch 3mtr	1
-	8M02500100400	8XM-25 MIG torch 4mtr	1
-	8M02500100500	8XM-25 MIG torch 5mtr	1

ITEM	PART NO.	DESCRIPTION	PACK QTY
SPARE PARTS			
1	300625	Swanneck	1
2	150102	Tipadaptor M6	10
	150106	Tipadaptor M8	10
3	100206	Contacttip M6-08-1,0mm	100
		Other contacttips, see: Options and wear parts	Page 48
4	200415	Nozzle conical	10
		Other nozzles, see: Options and wear parts	Page 52
5	258253	Cable assembly 25mm ² 3mtr	1
	258254	Cable assembly 25mm ² 4mtr	1
	258255	Cable assembly 25mm ² 5mtr	1
6	302535	P.C. liner red (ø 2,0/4,5mm round) 3mtr	1
	302545	P.C. liner red (ø 2,0/4,5mm round) 4mtr	1
	302555	P.C. liner red (ø 2,0/4,5mm round) 5mtr	1
		Other liners, see: Options and wear parts	Page 50
7	305620	Nozzle spring	1
8	305401	Lock nut M10x1x5mm	1
9	305400	Hexagonal fitting M10x1x26mm	1
10	305500	Plastic body	5



ITEM	PART NO.	DESCRIPTION	PACK QTY
SPARE PARTS			
11	8M9918	8XM Handle complete 16mm	1
12	8M9300	8XM Locking nut	1
13	8M9154	8XM Bottom cap standard	1
14	8M9352	8XM Trigger	1
	361192	8XM Spring for switch	5
	8M8900	8XM Micro switch	1
15	501151	Screw	25
16	8M9200	8XM Locking cap	1
17	8M9254	8XM Swanneck adapter 16mm	1
18	8M9100	8XM Blind cap	1
19	8M9601	Cable support	1
20	8M9419	8XM Locking ring	1
21	8M9400	8XM Housing for central connector	1
22	305310	Screw M4 X 6	25
23	305298	Central connector Euro with spring pin	1
24	305309	Spring pin complete	10
25	305316	Liner positioner nut	10
26	8M9420	8XM Adaptor nut	1
27	8M9500	Cable support spring	1

COMFORTABLE



8XM - 25SN MIG TORCH

CO2 - 230 AMP, MIXED GASES - 200 AMP, DUTY CYCLE - 60%

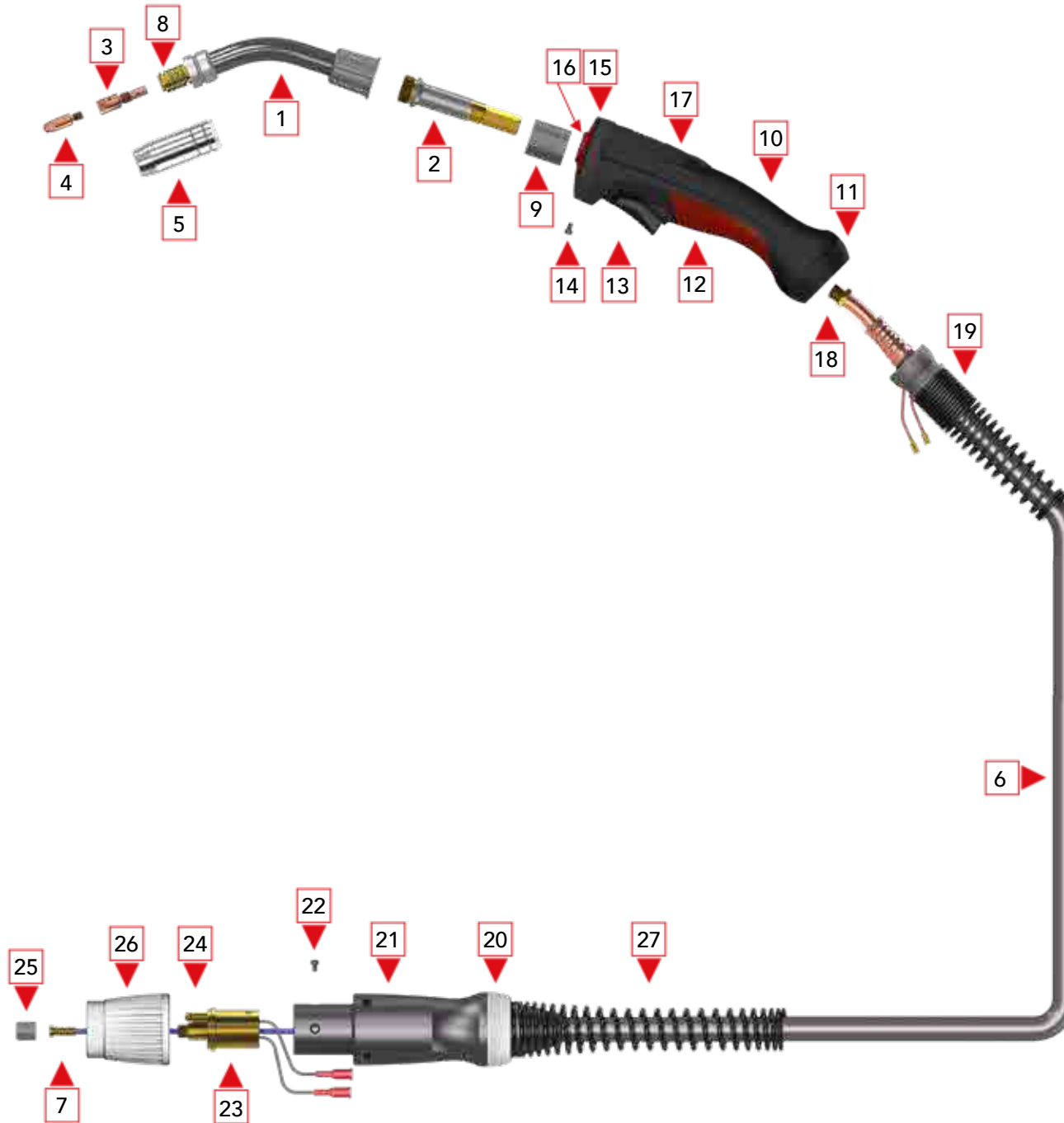

AIR COOLED

HEAVY DUTY

ITEM	PART NO.	DESCRIPTION	PACK QTY
COMPLETE TORCHES			
-	8M02700100300	8XM-25SN MIG torch 3mtr	1
-	8M02700100400	8XM-25SN MIG torch 4mtr	1
-	8M02700100500	8XM-25SN MIG torch 5mtr	1

ITEM	PART NO.	DESCRIPTION	PACK QTY
SPARE PARTS			
1	300405	SN Swanneck	1
2	204070	SN Connection part	1
3	150102	Tipadaptor M6	10
	150106	Tipadaptor M8	10
4	100206	Contacttip M6-08-1,0mm	100
		Other contacttips, see: Options and wear parts	Page 48
5	200415	Nozzle conical	10
		Other nozzles, see: Options and wear parts	Page 52
6	258253	Cable assembly 25mm ² 3mtr	1
	258254	Cable assembly 25mm ² 4mtr	1
	258255	Cable assembly 25mm ² 5mtr	1
7	302535	P.C. liner red (ø 2,0/4,5mm round) 3mtr	1
	302545	P.C. liner red (ø 2,0/4,5mm round) 4mtr	1
	302555	P.C. liner red (ø 2,0/4,5mm round) 5mtr	1
		Other liners, see: Options and wear parts	Page 50
8	305620	Nozzle spring	10
9	305500	Plastic body	5
10	8M9918	8XM Handle complete 16mm	1



ITEM	PART NO.	DESCRIPTION	PACK QTY
SPARE PARTS			
11	8M9900	8XM Locking nut	1
12	8M9154	8XM Bottom cap standardt	1
13	8M9352	8XM Trigger	1
	8M9350	8XM Spring for switch	5
	8M8900	8XM Micro switch	1
14	501151	Screw	25
15	8M9200	8XM Locking cap	1
16	8M9254	8XM Swanneck adapter 16mm	1
17	8M9100	8XM Blind cap	1
18	305401	Lock nut M10x1x5mm	10
19	8M9601	Cable support	1
20	8M9419	8XM Locking ring	1
21	8M9400	8XM Housing for central connector	1
22	305310	Screw M4 X 6	25
23	305298	Central connector Euro with spring pin	1
24	305309	Spring pin complete	10
25	305316	Liner positioner nut	10
26	8M9420	8XM Adaptor nut	1
27	8M9500	Cable support spring	1

COMFORTABLE



8XM - 26 MIG TORCH

CO₂ - 230 AMP, MIXED GASES - 200 AMP, DUTY CYCLE - 60%



AIR COOLED

HEAVY DUTY

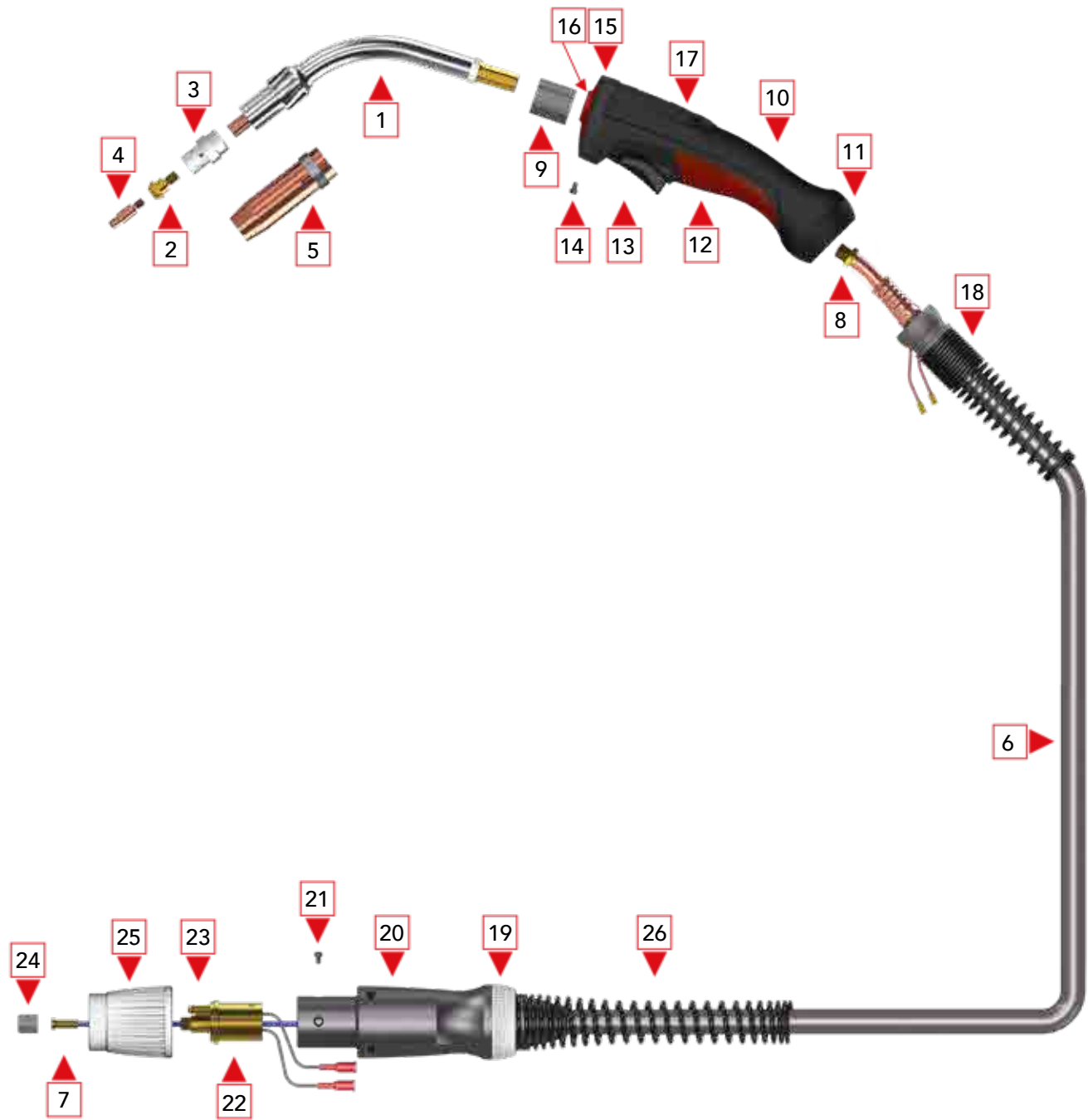

ITEM	PART NO.	DESCRIPTION	PACK QTY
COMPLETE TORCHES			
-	8M02600100300	8XM-26 MIG torch 3mtr	1
-	8M02600100400	8XM-26 MIG torch 4mtr	1
-	8M02600100500	8XM-26 MIG torch 5mtr	1

ITEM	PART NO.	DESCRIPTION	PACK QTY
SPARE PARTS			
1	300626	Swanneck	1
2	150202	Tipadaptor M6	10
	150203	Tipadaptor M8	10
3	300520	Diffuser white	25
	300525	Diffuser black	25
4	100206	Contacttip M6-08-1,0mm	100
		Other contacttips, see: Options and wear parts	Page 48
5	200810	Nozzle conical	10
		Other nozzles, see: Options and wear parts	Page 52
6	258253	Cable assembly 25mm ² 3mtr	1
	258254	Cable assembly 25mm ² 4mtr	1
	258255	Cable assembly 25mm ² 5mtr	1
7	302535	P.C. liner red (ø 2,0/4,5mm round) 3mtr	1
	302545	P.C. liner red (ø 2,0/4,5mm round) 4mtr	1
	302555	P.C. liner red (ø 2,0/4,5mm round) 5mtr	1
		Other liners, see: Options and wear parts	Page 50
8	305401	Lock nut M10x1x5mm	10
9	305500	Plastic body	5



ITEM	PART NO.	DESCRIPTION	PACK QTY
SPARE PARTS			
10	8M9918	8XM Handle complete 16mm	1
11	8M9300	8XM Locking nut	1
12	8M9154	8XM Bottom cap standard	1
13	8M9352	8XM Trigger	1
	361192	8XM Spring for switch	5
	8M8900	8XM Micro switch	1
14	501151	Screw	25
15	8M9200	8XM Locking cap	1
16	8M9254	8XM Swanneck adapter 16mm	1
17	8M9100	8XM Blind cap	1
18	8M9601	Cable support	1
19	8M9419	8XM Locking ring	1
20	8M9400	8XM Housing for central connector	1
21	305310	Screw M4 X 6	25
22	305298	Central connector Euro with spring pin	1
23	305309	Spring pin complete	10
24	305316	Liner positioner nut	10
25	8M9420	8XM Adaptor nut	1
26	8M9500	Cable support spring	1

COMFORTABLE



8XM - 36 MIG TORCH

CO₂ - 320 AMP, MIXED GASES - 300 AMP, DUTY CYCLE - 60%



AIR COOLED

HEAVY DUTY

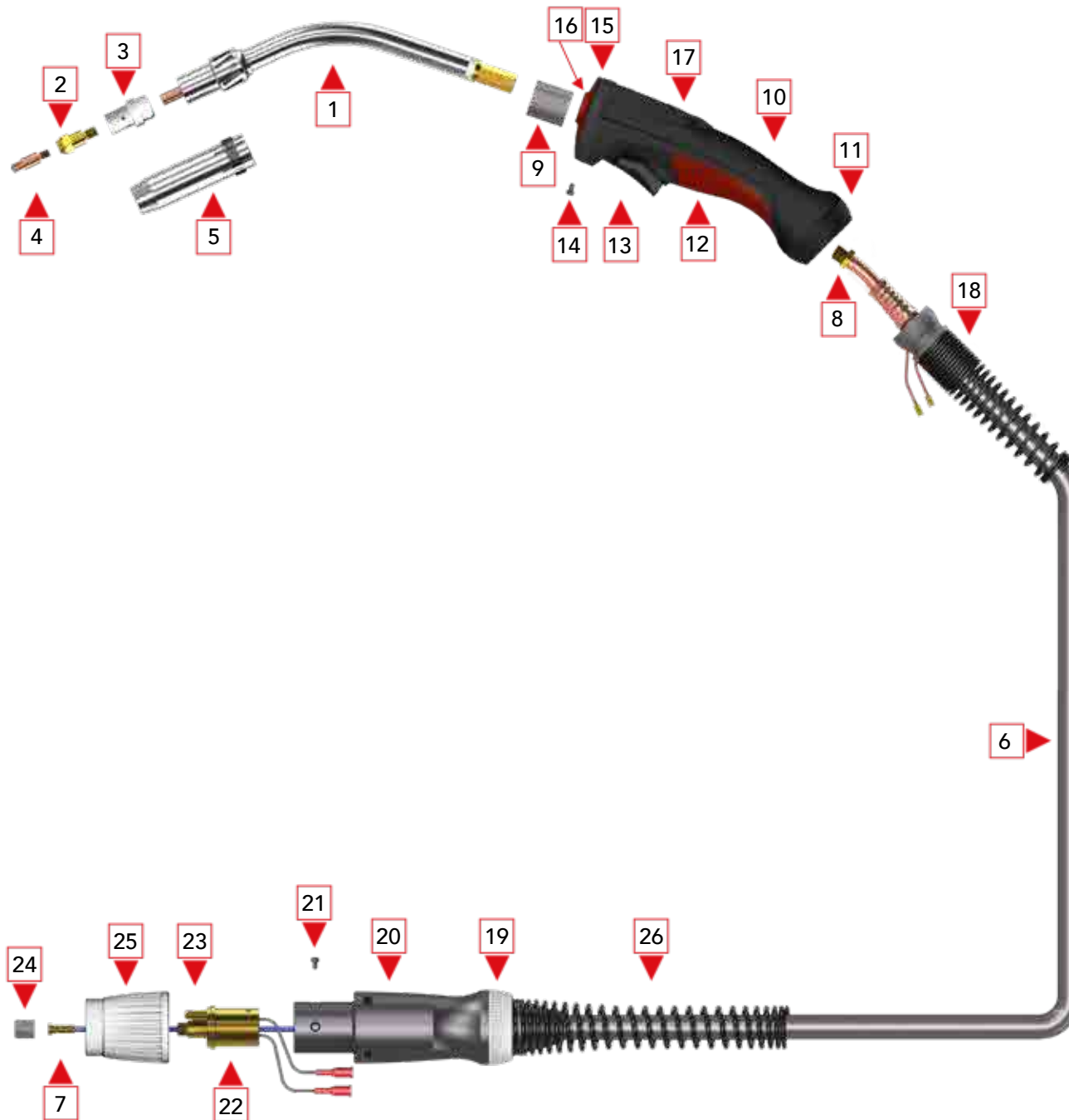

ITEM	PART NO.	DESCRIPTION	PACK QTY
COMPLETE TORCHES			
-	8M03600100300	8XM-36 MIG torch 3mtr	1
-	8M03600100400	8XM-36 MIG torch 4mtr	1
-	8M03600100500	8XM-36 MIG torch 5mtr	1

ITEM	PART NO.	DESCRIPTION	PACK QTY
SPARE PARTS			
1	300636	Swanneck	1
2	150302	Tipadaptor M6	10
	150304	Tipadaptor M8	10
3	300530	Diffuser white	25
	300540	Diffuser black	25
4	100208	Contacttip M6-08-1,2mm	100
		Other contacttips, see: Options and wear parts	Page 48
5	200610	Nozzle conical	10
		Other nozzles, see: Options and wear parts	Page 52
6	258363	Cable assembly 50mm ² 3mtr	1
	258364	Cable assembly 50mm ² 4mtr	1
	258365	Cable assembly 50mm ² 5mtr	1
7	302535	P.C. liner red (ø 2,0/4,5mm round) 3mtr	1
	302545	P.C. liner red (ø 2,0/4,5mm round) 4mtr	1
	302555	P.C. liner red (ø 2,0/4,5mm round) 5mtr	1
		Other liners, see: Options and wear parts	Page 50
8	305401	Lock nut M10x1x5mm	10
9	305500	Plastic body	5



ITEM	PART NO.	DESCRIPTION	PACK QTY
SPARE PARTS			
10	8M9918	8XM Handle complete 16mm	1
11	8M9300	8XM Locking nut	1
12	8M9154	8XM Bottom cap standard	1
13	8M9352	8XM Trigger	1
	361192	8XM Spring for switch	5
	8M8900	8XM Micro switch	1
14	501151	Screw	25
15	8M9200	8XM Locking cap	1
16	8M9254	8XM Swanneck adapter 16mm	1
17	8M9100	8XM Blind cap	1
18	8M9601	Cable support	1
19	8M9419	8XM Locking ring	1
20	8M9400	8XM Housing for central connector	1
21	305310	Screw M4 X 6	25
22	305298	Central connector Euro with spring pin	1
23	305309	Spring pin complete	10
24	305316	Liner positioner nut	10
25	8M9420	8XM Adaptor nut	1
26	8M9500	Cable support spring	1

COMFORTABLE



8XM - 36SN MIG TORCH

CO2 - 320 AMP, MIXED GASES - 300 AMP, DUTY CYCLE - 60%



AIR COOLED

HEAVY DUTY

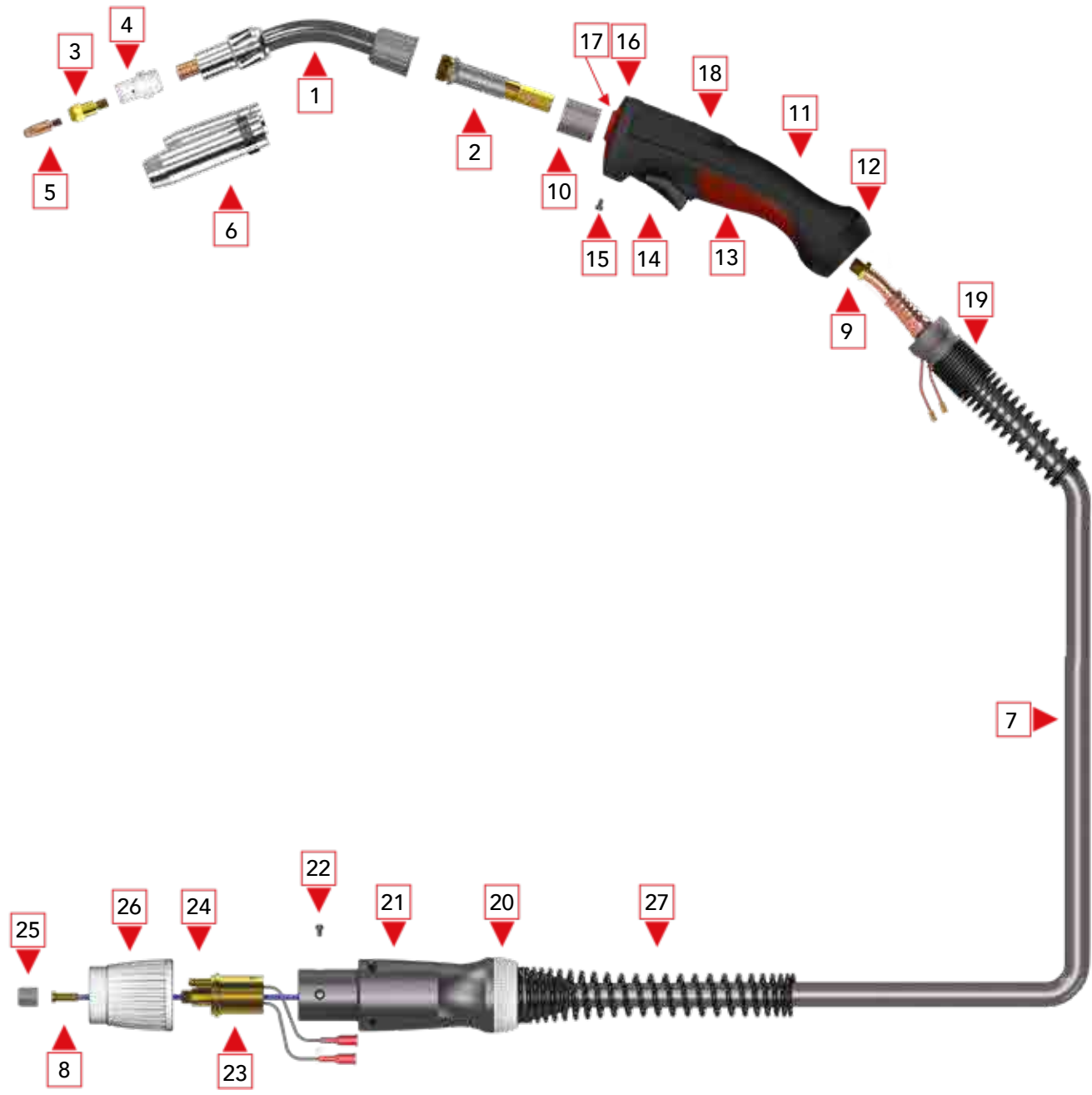

ITEM	PART NO.	DESCRIPTION	PACK QTY
COMPLETE TORCHES			
-	8M03700100300	8XM-36SN MIG torch 3mtr	1
-	8M03700100400	8XM-36SN MIG torch 4mtr	1
-	8M03700100500	8XM-36SN MIG torch 5mtr	1

ITEM	PART NO.	DESCRIPTION	PACK QTY
SPARE PARTS			
1	300410	SN Swanneck	1
2	204070	SN Connection part	1
3	150302	Tipadaptor M6	10
	150304	Tipadaptor M8	10
4	300530	Diffuser white	25
	300540	Diffuser black	25
5	100208	Contacttip M6-08-1,2mm	100
		Other contacttips, see: Options and wear parts	Page 48
6	200610	Nozzle conical	10
		Other nozzles, see: Options and wear parts	Page 52
7	258363	Cable assembly 50mm ² 3mtr	1
	258364	Cable assembly 50mm ² 4mtr	1
	258365	Cable assembly 50mm ² 5mtr	1
8	302535	P.C. liner red (ø 2,0/4,5mm round) 3mtr	1
	302545	P.C. liner red (ø 2,0/4,5mm round) 4mtr	1
	302555	P.C. liner red (ø 2,0/4,5mm round) 5mtr	1
		Other liners, see: Options and wear parts	Page 50
9	305401	Lock nut M10x1x5mm	10
10	305500	Plastic body	5



ITEM	PART NO.	DESCRIPTION	PACK QTY
SPARE PARTS			
11	8M9918	8XM Handle complete 16mm	1
12	8M9300	8XM Locking nut	1
13	8M9154	8XM Bottom cap standard	1
14	8M9352	8XM Trigger	1
	361192	8XM Spring for switch	5
	8M8900	8XM Micro switch	1
15	501151	Screw	25
16	8M9200	8XM Locking cap	1
17	8M9254	8XM Swanneck adapter 16mm	1
18	8M9100	8XM Blind cap	1
19	8M9601	Cable support	1
20	8M9419	8XM Locking ring	1
21	8M9400	8XM Housing for central connector	1
22	305310	Screw M4 X 6	25
23	305298	Central connector Euro with spring pin	1
24	305309	Spring pin complete	10
25	305316	Liner positioner nut	10
26	8M9420	8XM Adaptor nut	1
27	8M9500	Cable support spring	1

COMFORTABLE



8XM - 38 MIG TORCH

CO2 - 350 AMP, MIXED GASES - 320 AMP, DUTY CYCLE - 60%



AIR COOLED

HEAVY DUTY

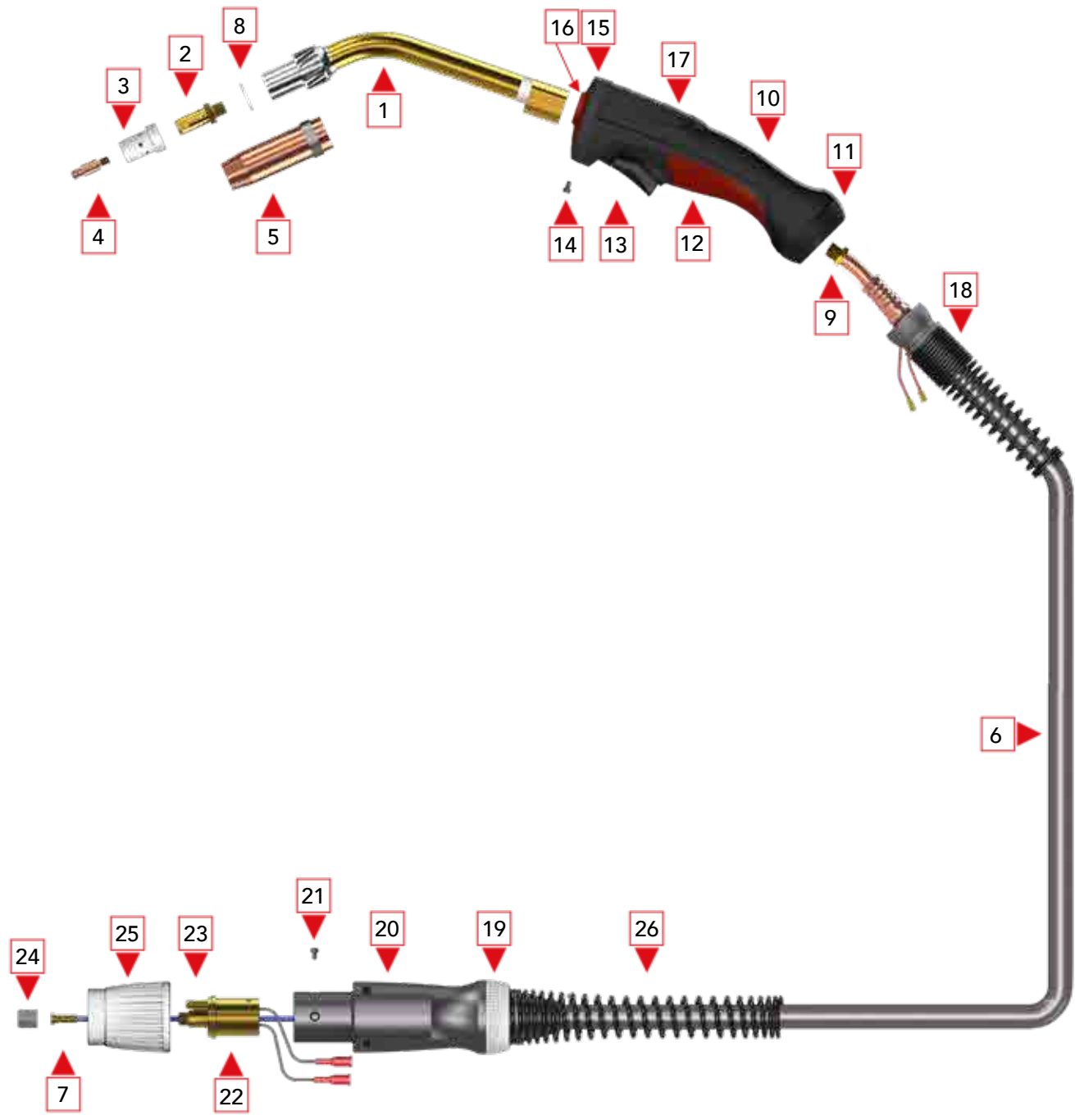

ITEM	PART NO.	DESCRIPTION	PACK QTY
COMPLETE TORCHES			
-	8M03800100300	8XM-38 MIG torch 3mtr	1
-	8M03800100400	8XM-38 MIG torch 4mtr	1
-	8M03800100500	8XM-38 MIG torch 5mtr	1

ITEM	PART NO.	DESCRIPTION	PACK QTY
SPARE PARTS			
1	300638	Swanneck	1
2	150320	Tipadaptor M8	10
3	300560	Diffuser white	25
	300570	Diffuser black	25
4	100304	Contacttip M8-10-1,2mm	50
		Other contacttips, see: Options and wear parts	Page 48
5	200820	Nozzle conical (Heavy Duty)	10
		Other nozzles, see: Options and wear parts	Page 52
6	258363	Cable assembly 50mm ² 3mtr	1
	258364	Cable assembly 50mm ² 4mtr	1
	258365	Cable assembly 50mm ² 5mtr	1
7	302535	P.C. liner red (ø 2,0/4,5mm round) 3mtr	1
	302545	P.C. liner red (ø 2,0/4,5mm round) 4mtr	1
	302555	P.C. liner red (ø 2,0/4,5mm round) 5mtr	1
		Other liners, see: Options and wear parts	Page 50
8	305640	Insulating washer	1
9	305401	Lock nut M10x1x5mm	10



ITEM	PART NO.	DESCRIPTION	PACK QTY
SPARE PARTS			
10	8M9948	8XM Handle complete 18mm	1
11	8M9300	8XM Locking nut	1
12	8M9154	8XM Bottom cap standard	1
13	8M9352	8XM Trigger	1
	361192	8XM Spring for switch	5
	8M8900	8XM Micro switch	1
14	501151	Screw	25
15	8M9200	8XM Locking cap	1
16	8M9264	8XM Swanneck adapter 18mm	1
17	8M9100	8XM Blind cap	1
18	8M9601	Cable support	1
19	8M9419	8XM Locking ring	1
20	8M9400	8XM Housing for central connector	1
21	305310	Screw M4 X 6	25
22	305298	Central connector Euro with spring pin	1
23	305309	Spring pin complete	10
24	305316	Liner positioner nut	10
25	8M9420	8XM Adaptor nut	1
26	8M9500	Cable support spring	1

COMFORTABLE



8XM - 40 MIG TORCH

CO₂ - 400 AMP, MIXED GASES - 380 AMP, DUTY CYCLE - 60%



AIR COOLED

HEAVY DUTY

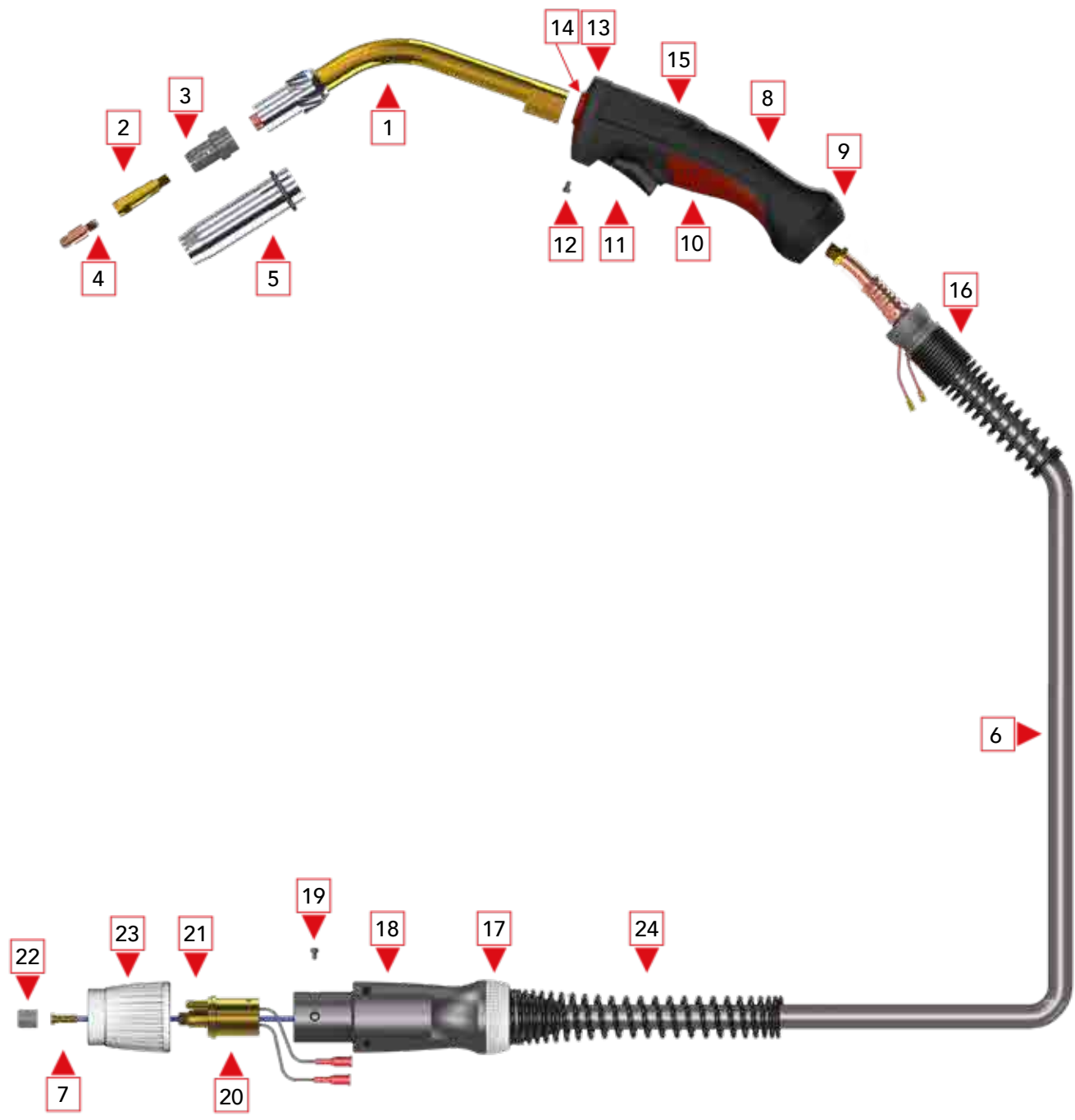

ITEM	PART NO.	DESCRIPTION	PACK QTY
COMPLETE TORCHES			
-	8M04000100300	8XM-40 MIG torch 3mtr	1
-	8M04000100400	8XM-40 MIG torch 4mtr	1
-	8M04000100500	8XM-40 MIG torch 5mtr	1

ITEM	PART NO.	DESCRIPTION	PACK QTY
SPARE PARTS			
1	300640	Swanneck	1
2	150325	Tipadaptor M8	10
3	300550	Diffuser black	25
4	100304	Contacttip M8-10-1,2mm	50
		Other contacttips, see: Options and wear parts	Page 48
5	200710	Nozzle conical	10
	200700	Nozzle cylindrical	10
		Other nozzles, see: Options and wear parts	Page 52
6	258403	Cable assembly 70mm ² 3mtr	1
	258404	Cable assembly 70mm ² 4mtr	1
	258405	Cable assembly 70mm ² 5mtr	1
7	303635	P.C. liner yellow (ø 2,5/4,5mm round) 3mtr	1
	303645	P.C. liner yellow (ø 2,5/4,5mm round) 4mtr	1
	303655	P.C. liner yellow (ø 2,5/4,5mm round) 5mtr	1
		Other liners, see: Options and wear parts	Page 50



ITEM	PART NO.	DESCRIPTION	PACK QTY
SPARE PARTS			
8	8M9948	8XM Handle complete 18mm	1
9	8M9300	8XM Locking nut	1
10	8M9154	8XM Bottom cap standard	1
11	8M9352	8XM Trigger	1
	361192	8XM Spring for switch	5
	8M8900	8XM Micro switch	1
12	501151	Screw	25
13	8M9200	8XM Locking cap	1
14	8M9264	8XM Swanneck adapter 18mm	1
15	8M9100	8XM Blind cap	1
16	8M9601	Cable support	1
17	8M9419	8XM Locking ring	1
18	8M9400	8XM Housing for central connector	1
19	305310	Screw M4 X 6	25
20	305301	Central connector Euro with spring pin	1
21	305309	Spring pin complete	10
22	305316	Liner positioner nut	10
23	8M9420	8XM Adaptor nut	1
24	8M9500	Cable support spring	1

COMFORTABLE



8XM - 240 MIG TORCH

CO2 - 300 AMP, MIXED GASES - 270 AMP, DUTY CYCLE - 100%



WATER COOLED

HEAVY DUTY

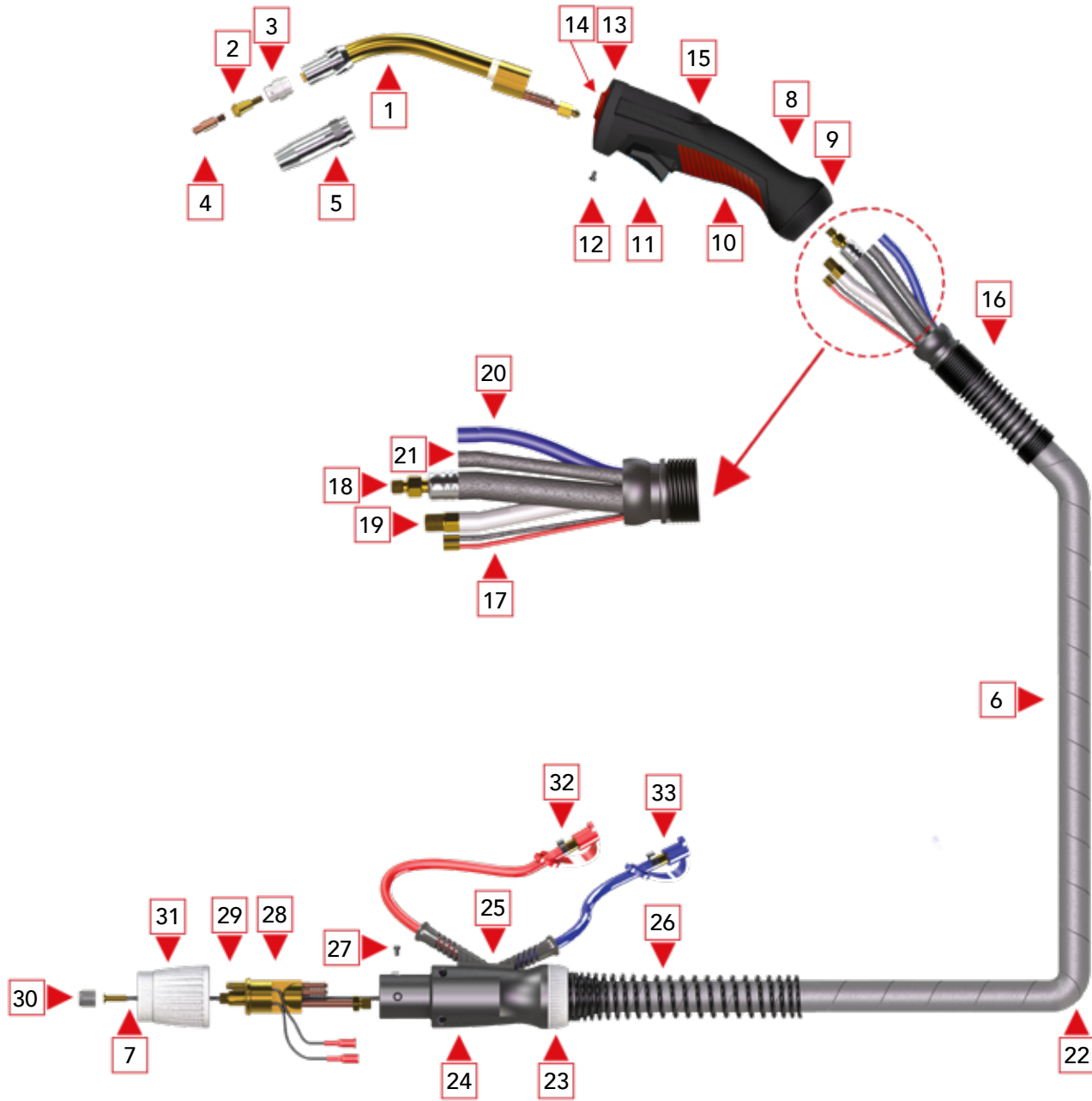

ITEM	PART NO.	DESCRIPTION	PACK QTY
COMPLETE TORCHES			
-	8M24000300300	8XM-240 MIG torch 3mtr	1
-	8M24000300400	8XM-240 MIG torch 4mtr	1
-	8M24000300500	8XM-240 MIG torch 5mtr	1

ITEM	PART NO.	DESCRIPTION	PACK QTY
SPARE PARTS			
1	300623	Swanneck	1
2	150002	Tipadaptor M6	10
3	300510	Diffuser white	25
4	100208	Contacttip M6-08-1,2mm	100
		Other contacttips, see: Options and wear parts	Page 48
5	200300	Nozzle conical	10
		Other nozzles, see: Options and wear parts	Page 52
6	258413	Cable assembly complete 3mtr	1
	258414	Cable assembly complete 4mtr	1
	258415	Cable assembly complete 5mtr	1
7	304635	Plain liner(ø 2,0/4,5mm round) 3mtr	1
	304645	Plain liner (ø 2,0/4,5mm round) 4mtr	1
	304655	Plain liner (ø 2,0/4,5mm round) 5mtr	1
		Other liners, see: Options and wear parts	Page 50
8	8M9918	8XM Handle complete 16mm	1
9	8M9300	8XM Locking nut	1
10	8M9154	8XM Bottom cap standard	1
11	8M9352	8XM Trigger	1
	361192	8XM Spring for switch	5
	8M8900	8XM Micro switch	1
12	501151	Screw	25
13	8M9200	8XM Locking cap	1
14	8M9254	8XM Swanneck adapter 16mm	1
15	8M9100	8XM Blind cap	1



ITEM	PART NO.	DESCRIPTION	PACK QTY
SPARE PARTS			
16	8M9602	Cable support with ball-and-socket joint (handle side)	1
17	306505	Switch cable 1x0,75mm² per mtr	100
18	258513	Power/water cable 3mtr	1
	258514	Power/water cable 4mtr	1
	258515	Power/water cable 5mtr	1
19	258523	Outer liner 3mtr	
	258524	Outer liner 4mtr	1
	258525	Outerliner 5mtr	1
20	258535	Water inlet hose 5x8mm blue per mtr	100
	258566	Water outlet hose 5x8mm red per mtr	100
21	258619	Gas hose 5x8mm black per mtr	100
22	259200	Canvas sheating 25x1,5mm per mtr	40
23	8M9419	8XM locking ring	1
24	8M9400	8XM Housing for central connector	1
25	350881	Water hose guide	1
26	358201	Cable support spring	1
27	305310	Screw M4x6	25
28	305304	Central connector Euro with spring pin	1
29	3053091	Spring pin complete	10
30	305316	Liner positioner nut	10
31	8M9420	8XM Adaptor nut	1
32	258701	Waterstop red	10
33	258702	Waterstop blue	10

COMFORTABLE



8XM - 352 MIG TORCH

CO2 - 360 AMP, MIXED GASES - 340 AMP, DUTY CYCLE - 100%

MIG
TORCHES

WATER COOLED

HEAVY DUTY

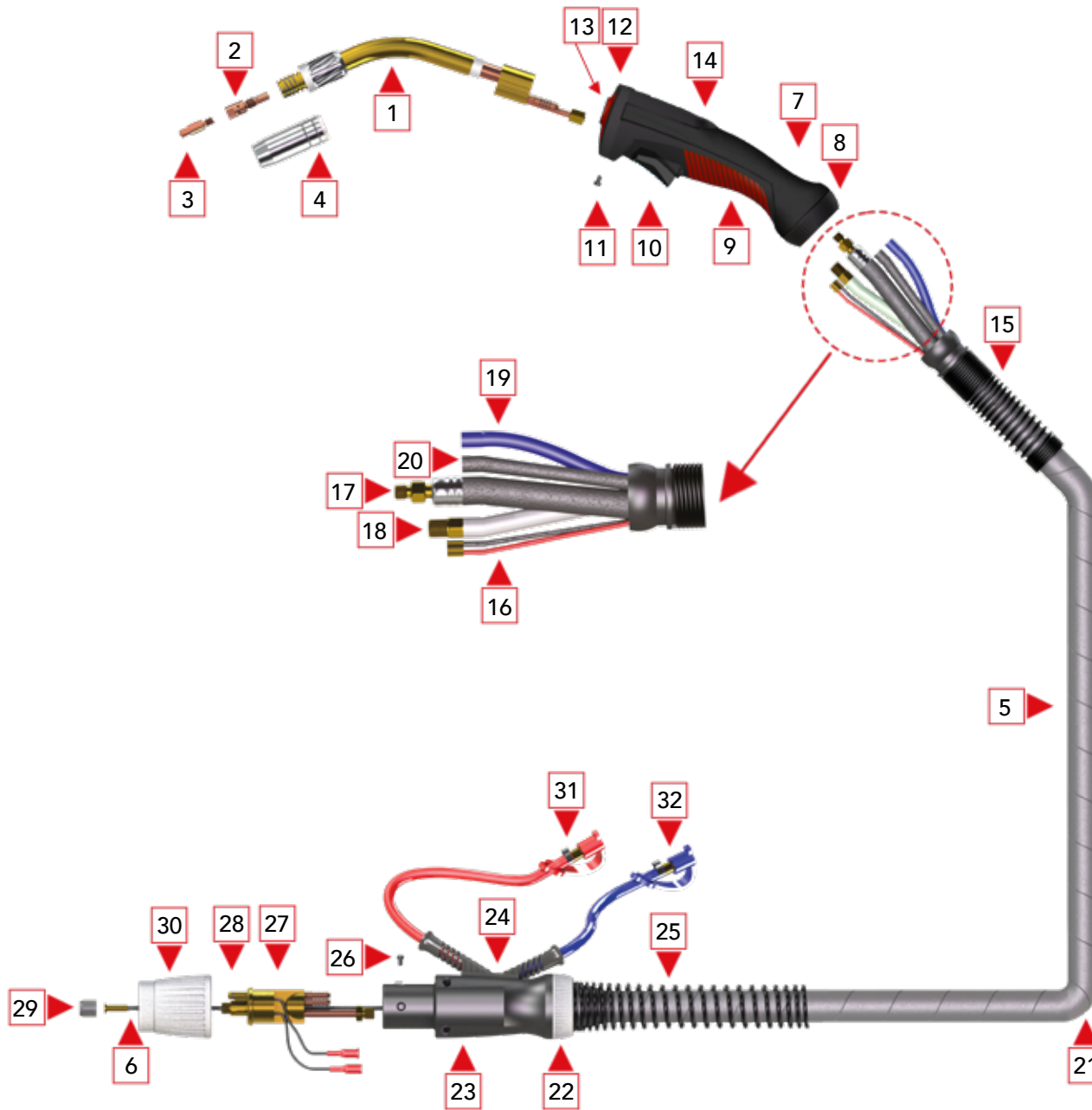

ITEM	PART NO.	DESCRIPTION	PACK QTY
COMPLETE TORCHES			
-	8M35200300300	8XM-352 MIG torch 3mtr	1
-	8M35200300400	8XM-352 MIG torch 4mtr	1
-	8M35200300500	8XM-352 MIG torch 5mtr	1

ITEM	PART NO.	DESCRIPTION	PACK QTY
SPARE PARTS			
1	300635	Swanneck	1
2	150102	Tipadaptor M6	10
	150106	Tipadaptor M8	10
3	100208	Contacttip M6-08-1,2mm	100
		Other contacttips, see: Options and wear parts	Page 48
4	200415	Nozzle conical	10
		Other nozzles, see: Options and wear parts	Page 52
5	258413	Cable assembly complete 3mtr	1
	258414	Cable assembly complete 4mtr	1
	258415	Cable assembly complete 5mtr	1
6	304635	Plain liner(ø 2,0/4,5mm round) 3mtr	1
	304645	Plain liner (ø 2,0/4,5mm round) 4mtr	1
	304655	Plain liner (ø 2,0/4,5mm round) 5mtr	1
		Other liners, see: Options and wear parts	Page 50
7	8M9918	8XM Handle complete 16mm	1
8	8M9300	8XM Locking nut	1
9	8M9154	8XM Bottom cap standard	1
10	8M9352	8XM Trigger	1
	361192	8XM Spring for switch	5
	8M8900	8XM Micro switch	1
11	501151	Screw	25
12	8M9200	8XM Locking cap	1
13	8M9254	8XM Swanneck adapter 16mm	1
14	8M9100	8XM Blind cap	1



ITEM	PART NO.	DESCRIPTION	PACK QTY
SPARE PARTS			
15	8M9602	Cable support with ball-and-socket joint (handle side)	1
16	306505	Switch cable 1x0,75mm² per mtr	100
17	258513	Power/water cable 3mtr	1
	258514	Power/water cable 4mtr	1
	258515	Power/water cable 5mtr	1
18	258523	Outer liner 3mtr	
	258524	Outer liner 4mtr	1
	258525	Outerliner 5mtr	1
19	258535	Water inlet hose 5x8mm blue per mtr	100
	258566	Water outlet hose 5x8mm red per mtr	100
20	258619	Gas hose 5x8mm black per mtr	100
21	259200	Canvas sheating 25x1,5mm per mtr	40
22	8M9419	8XM locking ring	1
23	8M9400	8XM Housing for central connector	1
24	350881	Water hose guide	1
25	358201	Cable support spring	1
26	305310	Screw M4x6	25
27	305304	Central connector Euro with spring pin	1
28	3053091	Spring pin complete	10
29	305316	Liner positioner nut	10
30	8M9420	8XM Adaptor nut	1
31	258701	Waterstop red	10
32	258702	Waterstop blue	10

COMFORTABLE



8XM - 410 MIG TORCH

CO2 - 500 AMP, MIXED GASES - 450 AMP, DUTY CYCLE - 100%



WATER COOLED

HEAVY DUTY

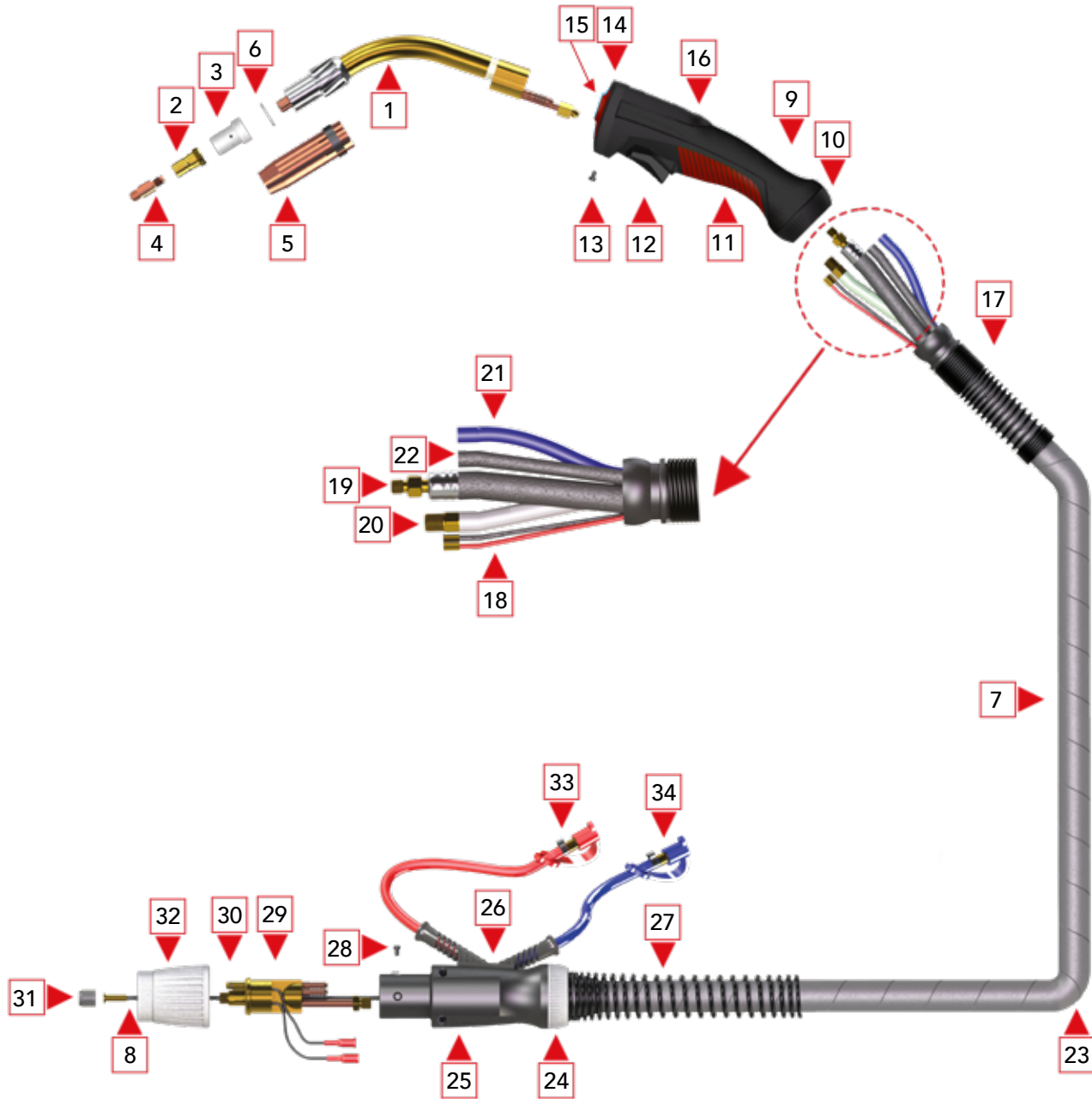

ITEM	PART NO.	DESCRIPTION	PACK QTY
COMPLETE TORCHES			
-	8M41000300300	8XM-410 MIG torch 3mtr	1
-	8M41000300400	8XM-410 MIG torch 4mtr	1
-	8M41000300500	8XM-410 MIG torch 5mtr	1

ITEM	PART NO.	DESCRIPTION	PACK QTY
SPARE PARTS			
1	300641	Swanneck (18mm Swanneck)	1
2	150404	Tipadaptor M8	10
	150402	Tipadaptor M6	10
3	300560	Diffuser white	25
	300570	Diffuser black	25
4	100304	Contacttip M8-10-1,2mm	50
		Other contacttips, see: Options and wear parts	Page 48
5	200820	Nozzle conical (Heavy Duty)	10
		Other nozzles, see: Options and wear parts	Page 52
6	305640	Insulasting washer	10
7	258413	Cable assembly complete 3mtr	1
	258414	Cable assembly complete 4mtr	1
	258415	Cable assembly complete 5mtr	1
8	304635	Plain liner(ø 2,0/4,5mm round) 3mtr	1
	304645	Plain liner (ø 2,0/4,5mm round) 4mtr	1
	304655	Plain liner (ø 2,0/4,5mm round) 5mtr	1
		Other liners, see: Options and wear parts	Page 50
9	8M9948	8XM Handle complete 18mm	1
10	8M9300	8XM Locking nut	1
11	8M9154	8XM Bottom cap standard	1
12	8M9352	8XM Trigger	1
	361192	8XM Spring for switch	5
	8M8900	8XM Micro switch	1
13	501151	Screw	25



ITEM	PART NO.	DESCRIPTION	PACK QTY
SPARE PARTS			
14	8M9200	8XM Locking cap	1
15	8M9264	8XM Swanneck adapter 18mm	1
16	8M9100	8XM Blind cap	1
17	8M9602	Cable support with ball-and-socket joint (handle side)	1
18	306505	Switch cable 1x0,75mm² per mtr	100
19	258513	Power/water cable 3mtr	1
	258514	Power/water cable 4mtr	1
	258515	Power/water cable 5mtr	1
20	258523	Outer liner 3mtr	
	258524	Outer liner 4mtr	1
	258525	Outerliner 5mtr	1
21	258535	Water inlet hose 5x8mm blue per mtr	100
	258566	Water outlet hose 5x8mm red per mtr	100
22	258619	Gas hose 5x8mm black per mtr	100
23	259200	Canvas sheating 25x1,5mm per mtr	40
24	8M9419	8XM locking ring	1
25	8M9400	8XM Housing for central connector	1
26	350881	Water hose guide	1
27	358201	Cable support spring	1
28	305310	Screw M4x6	25
29	305304	Central connector Euro with spring pin	1
30	3053091	Spring pin complete	10
31	305316	Liner positioner nut	10
32	8M9420	8XM Adaptor nut	1
33	258701	Waterstop red	10
34	258702	Waterstop blue	10

COMFORTABLE



8XM - 410SN MIG TORCH

CO2 - 500 AMP, MIXED GASES - 450 AMP, DUTY CYCLE - 100%



WATER COOLED

HEAVY DUTY

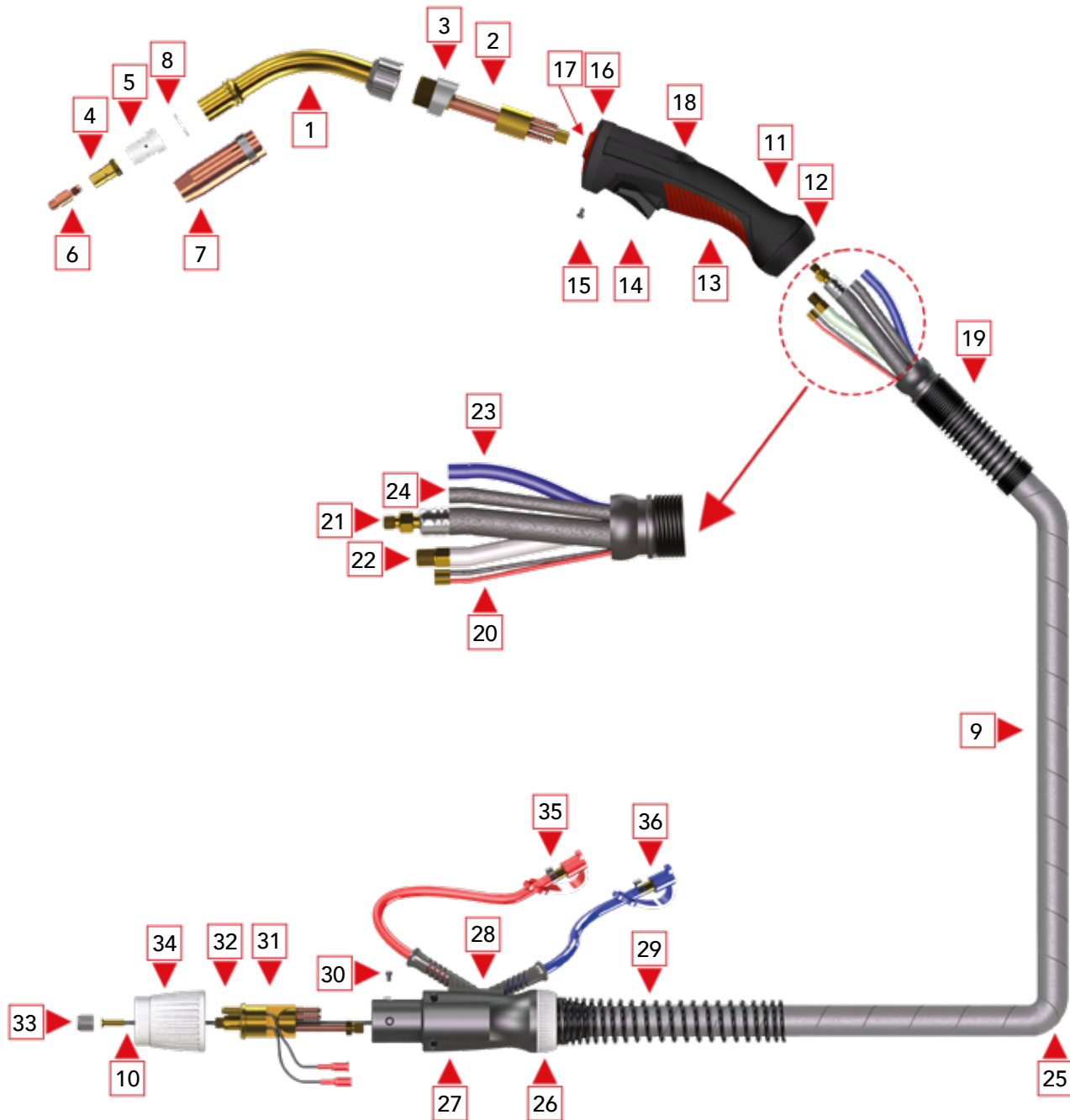

ITEM	PART NO.	DESCRIPTION	PACK QTY
COMPLETE TORCHES			
-	8M43100300300	8XM-410SN MIG torch 3mtr	1
-	8M43100300400	8XM-410SN MIG torch 4mtr	1
-	8M43100300500	8XM-410SN MIG torch 5mtr	1

ITEM	PART NO.	DESCRIPTION	PACK QTY
SPARE PARTS			
1	300094	SN Swanneck	1
2	300095	SN Connection part	10
3	310009	SN Connection ring	10
4	150404	Tipadaptor M8	10
	150402	Tipadaptor M6	10
5	300560	Diffuser white	25
	300570	Diffuser black	25
6	100304	Contacttip M8-10-1,2mm	50
		Other contacttips, see: Options and wear parts	Page 48
7	200820	Nozzle conical (Heavy Duty)	10
		Other nozzles, see: Options and wear parts	Page 52
8	305640	Insulating washer	10
9	258413	Cable assembly complete 3mtr	1
	258414	Cable assembly complete 4mtr	1
	258415	Cable assembly complete 5mtr	1
10	304635	Plain liner(ø 2,0/4,5mm round) 3mtr	1
	304645	Plain liner (ø 2,0/4,5mm round) 4mtr	1
	304655	Plain liner (ø 2,0/4,5mm round) 5mtr	1
		Other liners, see: Options and wear parts	Page 50
11	8M9948	8XM Handle complete 18mm	1
12	8M9300	8XM Locking nut	1
13	8M9154	8XM Bottom cap standard	1
14	8M9352	8XM Trigger	1
	361192	8XM Spring for switch	5



ITEM	PART NO.	DESCRIPTION	PACK QTY
SPARE PARTS			
	8M8900	8XM Micro switch	1
15	501151	Screw	25
16	8M9200	8XM Locking cap	1
17	8M9264	8XM Swanneck adapter 18mm	1
18	8M9100	8XM Blind cap	1
19	8M9602	Cable support with ball-and-socket joint (handle side)	1
20	306505	Switch cable 1x0,75mm² per mtr	100
21	258513	Power/water cable 3mtr	1
	258514	Power/water cable 4mtr	1
	258515	Power/water cable 5mtr	1
22	258523	Outer liner 3mtr	
	258524	Outer liner 4mtr	1
	258525	Outerliner 5mtr	1
23	258535	Water inlet hose 5x8mm blue per mtr	100
	258566	Water outlet hose 5x8mm red per mtr	100
24	258619	Gas hose 5x8mm black per mtr	100
25	259200	Canvas sheathing 25x1,5mm per mtr	40
26	8M9419	8XM locking ring	1
27	8M9400	8XM Housing for central connector	1
28	350881	Water hose guide	1
29	358201	Cable support spring	1
30	305310	Screw M4x6	25
31	305304	Central connector Euro with spring pin	1
32	3053091	Spring pin complete	10
33	305316	Liner positioner nut	10
34	8M9420	8XM Adaptor nut	1
35	258701	Waterstop red	10
36	258702	Waterstop blue	10

COMFORTABLE



8XM - 450 MIG TORCH

CO₂ - 550 AMP, MIXED GASES - 500 AMP, DUTY CYCLE - 100%

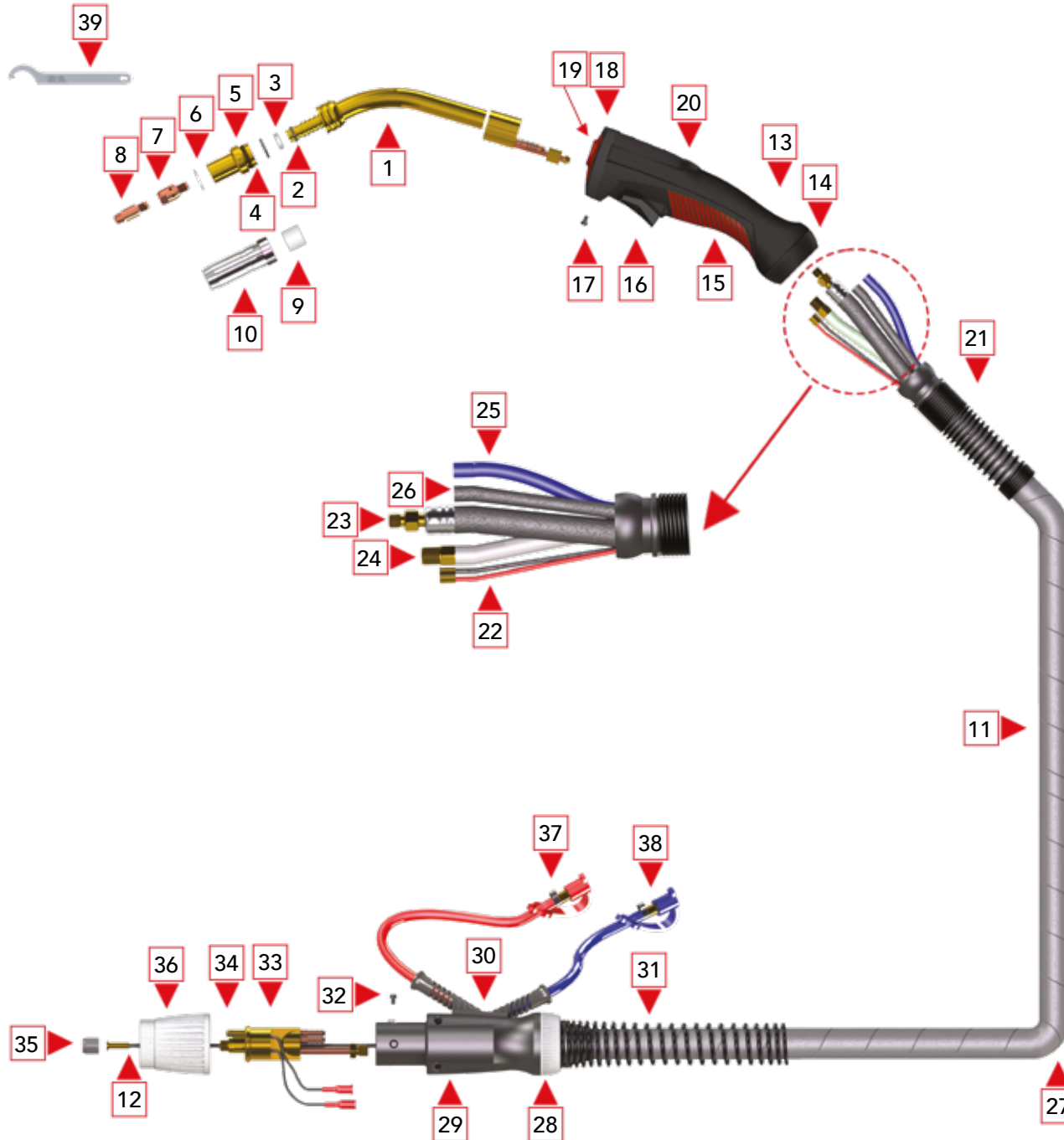

WATER COOLED

HEAVY DUTY



ITEM	PART NO.	DESCRIPTION	PACK QTY
COMPLETE TORCHES			
-	8M45000300300	8XM-450 MIG torch 3mtr	1
-	8M45000300400	8XM-450 MIG torch 4mtr	1
-	8M45000300500	8XM-450 MIG torch 5mtr	1

ITEM	PART NO.	DESCRIPTION	PACK QTY
SPARE PARTS			
1	3007145	Swanneck	1
2	305682	O-ring	10
3	3007139	Center ring	10
4	305674	O-ring	10
5	3007145001	Nozzle holder	10
6	3056945	Insulating washer	25
7	153458	Tipadaptor M8	10
8	100304	Contacttip M8-10-1,2mm	50
		Other contacttips, see: Options and wear parts	Page 48
9	20071459	Insulator for nozzle	5
10	2007145	Nozzle conical 14.5mm	10
		Other nozzles, see: Options and wear parts	Page 52
11	258413	Cable assembly complete 3mtr	1
	258414	Cable assembly complete 4mtr	1
	258415	Cable assembly complete 5mtr	1
12	304635	Plain liner(ø 2,0/4,5mm round) 3mtr	1
	304645	Plain liner (ø 2,0/4,5mm round) 4mtr	1
	304655	Plain liner (ø 2,0/4,5mm round) 5mtr	1
		Other liners, see: Options and wear parts	Page 50
13	8M9948	8XM Handle complete 18mm	1
14	8M9300	8XM Locking nut	1
15	8M9154	8XM Bottom cap standard	1
16	8M9352	8XM Trigger	1
	361192	8XM Spring for switch	5

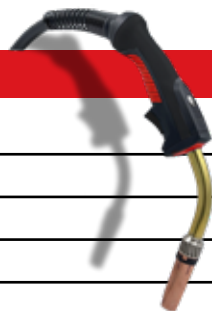

ITEM	PART NO.	DESCRIPTION	PACK QTY
SPARE PARTS			
	8M8900	8XM Micro switch	1
17	501151	Screw	25
18	8M9200	8XM Locking cap	1
19	8M9264	8XM Swanneck adapter 18mm	1
20	8M9100	8XM Blind cap	1
21	8M9602	Cable support with ball-and-socket joint (handle side)	1
22	306505	Switch cable 1x0,75mm² per mtr	100
23	258513	Power/water cable 3mtr	1
	258514	Power/water cable 4mtr	1
	258515	Power/water cable 5mtr	1
24	258523	Outer liner 3mtr	
	258524	Outer liner 4mtr	1
	258525	Outerliner 5mtr	1
25	258535	Water inlet hose 5x8mm blue per mtr	100
	258566	Water outlet hose 5x8mm red per mtr	100
26	258619	Gas hose 5x8mm black per mtr	100
27	259200	Canvas sheathing 25x1,5mm per mtr	40
28	8M9419	8XM locking ring	1
29	8M9400	8XM Housing for central connector	1
30	350881	Water hose guide	1
31	358201	Cable support spring	1
32	305310	Screw M4x6	25
33	305304	Central connector Euro with spring pin	1
34	3053091	Spring pin complete	10
35	305316	Liner positioner nut	10
36	8M9420	8XM Adaptor nut	1
37	258701	Waterstop red	10
38	258702	Waterstop blue	10
39	290100	Spanner for nozzle holder	1

COMFORTABLE



8XM - 510 MIG TORCH

CO2 - 550 AMP, MIXED GASES - 500 AMP, DUTY CYCLE - 100%



WATER COOLED

HEAVY DUTY

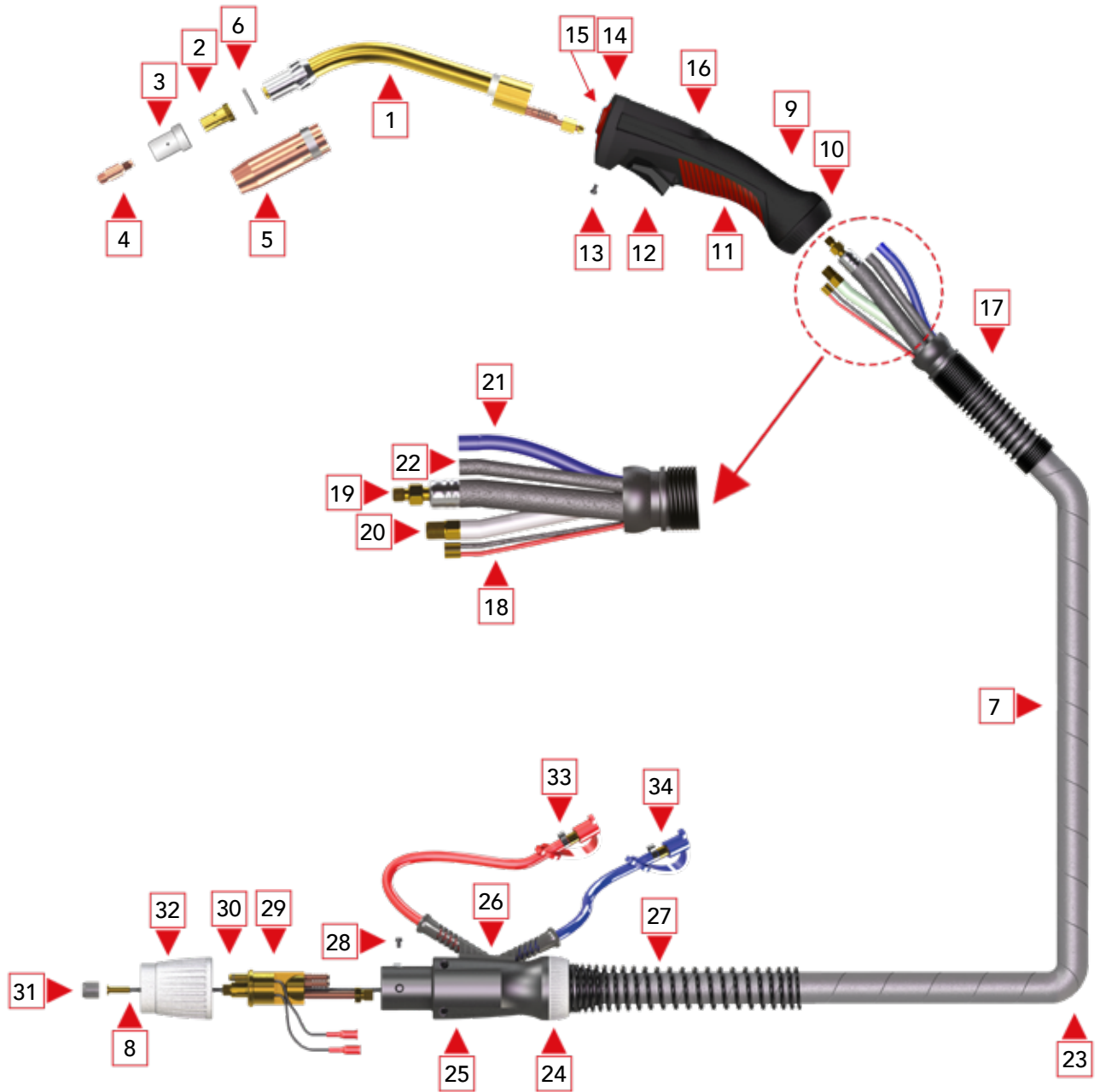

ITEM	PART NO.	DESCRIPTION	PACK QTY
COMPLETE TORCHES			
-	8M51000300300	8XM-510 MIG torch 3mtr	1
-	8M51000300400	8XM-510 MIG torch 4mtr	1
-	8M51000300500	8XM-510 MIG torch 5mtr	1

ITEM	PART NO.	DESCRIPTION	PACK QTY
SPARE PARTS			
1	300651	Swanneck (18mm Swanneck)	1
2	150404	Tipadaptor M8	10
	150402	Tipadaptor M6	10
3	300560	Diffuser white	25
	300570	Diffuser black	25
4	100304	Contacttip M8-10-1,2mm	50
		Other contacttips, see: Options and wear parts	Page 48
5	200820	Nozzle conical (Heavy Duty)	10
		Other nozzles, see: Options and wear parts	Page 52
6	305640	Insulasting washer	10
7	258413	Cable assembly complete 3mtr	1
	258414	Cable assembly complete 4mtr	1
	258415	Cable assembly complete 5mtr	1
8	304635	Plain liner(ø 2,0/4,5mm round) 3mtr	1
	304645	Plain liner (ø 2,0/4,5mm round) 4mtr	1
	304655	Plain liner (ø 2,0/4,5mm round) 5mtr	1
		Other liners, see: Options and wear parts	Page 50
9	8M9948	8XM Handle complete 18mm	1
10	8M9300	8XM Locking nut	1
11	8M9154	8XM Bottom cap standard	1
12	8M9352	8XM Trigger	1
	361192	8XM Spring for switch	5
	8M8900	8XM Micro switch	1
13	501151	Screw	25

ITEM	PART NO.	DESCRIPTION	PACK QTY
SPARE PARTS			
14	8M9200	8XM Locking cap	1
15	8M9264	8XM Swanneck adapter 18mm	1
16	8M9100	8XM Blind cap	1
17	8M9602	Cable support with ball-and-socket joint (handle side)	1
18	306505	Switch cable 1x0,75mm ² per mtr	100
19	258513	Power/water cable 3mtr	1
	258514	Power/water cable 4mtr	1
	258515	Power/water cable 5mtr	1
20	258523	Outer liner 3mtr	
	258524	Outer liner 4mtr	1
	258525	Outerliner 5mtr	1
21	258535	Water inlet hose 5x8mm blue per mtr	100
	258566	Water outlet hose 5x8mm red per mtr	100
22	258619	Gas hose 5x8mm black per mtr	100
23	259200	Canvas sheating 25x1,5mm per mtr	40
24	8M9419	8XM locking ring	1
25	8M9400	8XM Housing for central connector	1
26	350881	Water hose guide	1
27	358201	Cable support spring	1
28	305310	Screw M4x6	25
29	305304	Central connector Euro with spring pin	1
30	3053091	Spring pin complete	10
31	305316	Liner positioner nut	10
32	8M9420	8XM Adaptor nut	1
33	258701	Waterstop red	10
34	258702	Waterstop blue	10

COMFORTABLE

8XM - 550 MIG TORCH

CO2 - 550 AMP, MIXED GASES - 500 AMP, DUTY CYCLE - 100%



WATER COOLED

HEAVY DUTY

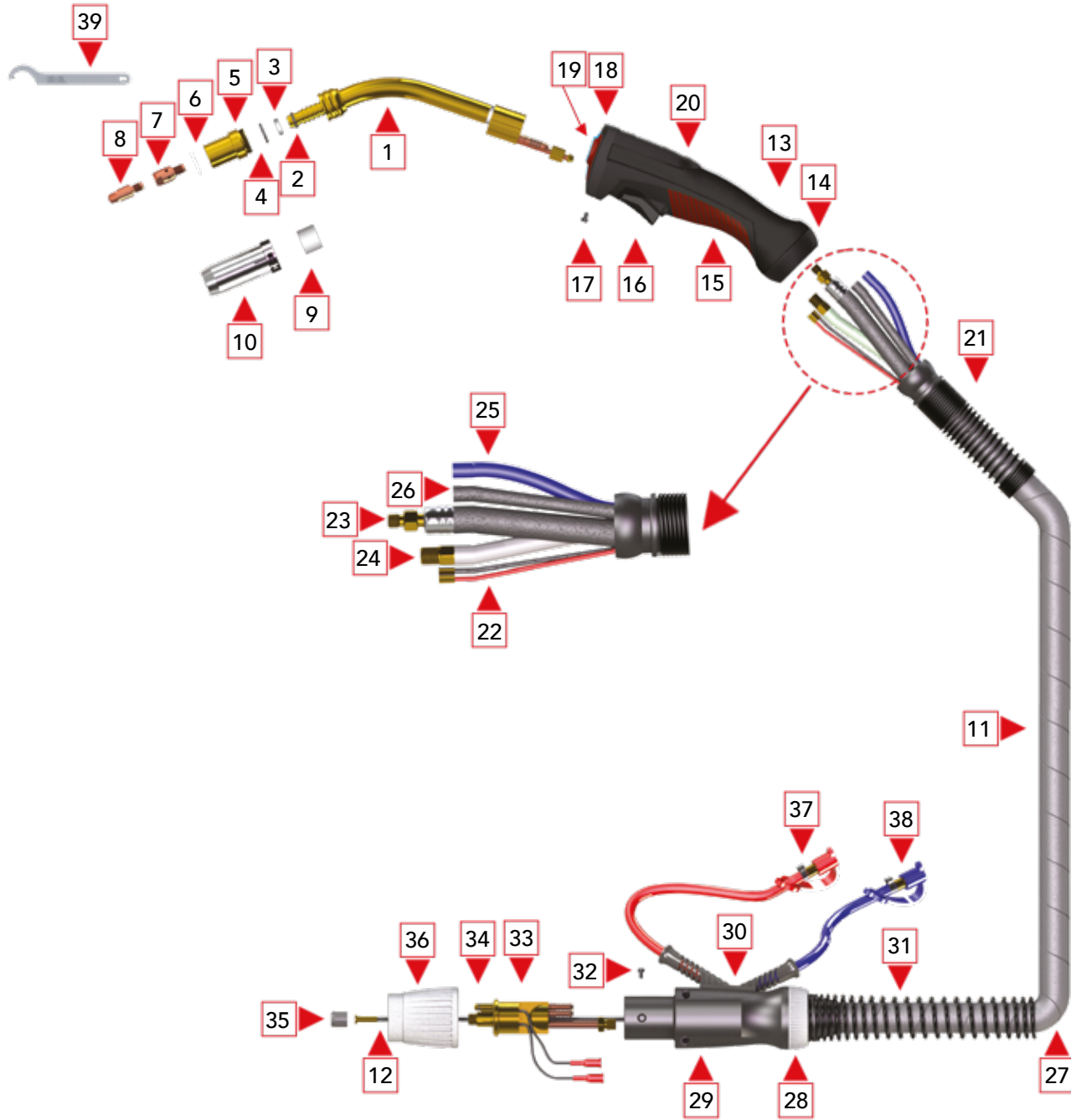

ITEM	PART NO.	DESCRIPTION	PACK QTY
COMPLETE TORCHES			
-	8M55000300300	8XM-550 MIG torch 3mtr	1
-	8M55000300400	8XM-550 MIG torch 4mtr	1
-	8M55000300500	8XM-550 MIG torch 5mtr	1

ITEM	PART NO.	DESCRIPTION	PACK QTY
SPARE PARTS			
1	3007155	Swanneck	1
2	305682	O-ring	10
3	3007139	Center ring	10
4	305674	O-ring	10
5	3007155001	Nozzle holder	10
6	3056955	Insulating washer	25
7	153458	Tipadaptor M8	10
8	100304	Contacttip M8-10-1,2mm	100
		Other contacttips, see: Options and wear parts	Page 48
9	20071459	Insulator for nozzle	5
10	2007155	Nozzle conical 14.5mm	10
		Other nozzles, see: Options and wear parts	Page 52
11	258413	Cable assembly complete 3mtr	1
	258414	Cable assembly complete 4mtr	1
	258415	Cable assembly complete 5mtr	1
12	304635	Plain liner(ø 2,0/4,5mm round) 3mtr	1
	304645	Plain liner (ø 2,0/4,5mm round) 4mtr	1
	304655	Plain liner (ø 2,0/4,5mm round) 5mtr	1
		Other liners, see: Options and wear parts	Page 50
13	8M9948	8XM Handle complete 18mm	1
14	8M9300	8XM Locking nut	1
15	8M9154	8XM Bottom cap standard	1
16	8M9352	8XM Trigger	1
	361192	8XM Spring for switch	5

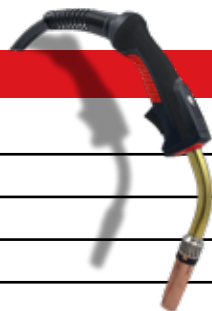

ITEM	PART NO.	DESCRIPTION	PACK QTY
SPARE PARTS			
	8M8900	8XM Micro switch	1
17	501151	Screw	25
18	8M9200	8XM Locking cap	1
19	8M9264	8XM Swanneck adapter 18mm	1
20	8M9100	8XM Blind cap	1
21	8M9602	Cable support with ball-and-socket joint (handle side)	1
22	306505	Switch cable 1x0,75mm² per mtr	100
23	258513	Power/water cable 3mtr	1
	258514	Power/water cable 4mtr	1
	258515	Power/water cable 5mtr	1
24	258523	Outer liner 3mtr	
	258524	Outer liner 4mtr	1
	258525	Outerliner 5mtr	1
25	258535	Water inlet hose 5x8mm blue per mtr	100
	258566	Water outlet hose 5x8mm red per mtr	100
26	258619	Gas hose 5x8mm black per mtr	100
27	259200	Canvas sheathing 25x1,5mm per mtr	40
28	8M9419	8XM locking ring	1
29	8M9400	8XM Housing for central connector	1
30	350881	Water hose guide	1
31	358201	Cable support spring	1
32	305310	Screw M4x6	25
33	305304	Central connector Euro with spring pin	1
34	3053091	Spring pin complete	10
35	305316	Liner positioner nut	10
36	8M9420	8XM Adaptor nut	1
37	258701	Waterstop red	10
38	258702	Waterstop blue	10
39	290100	Spanner for nozzle holder	1

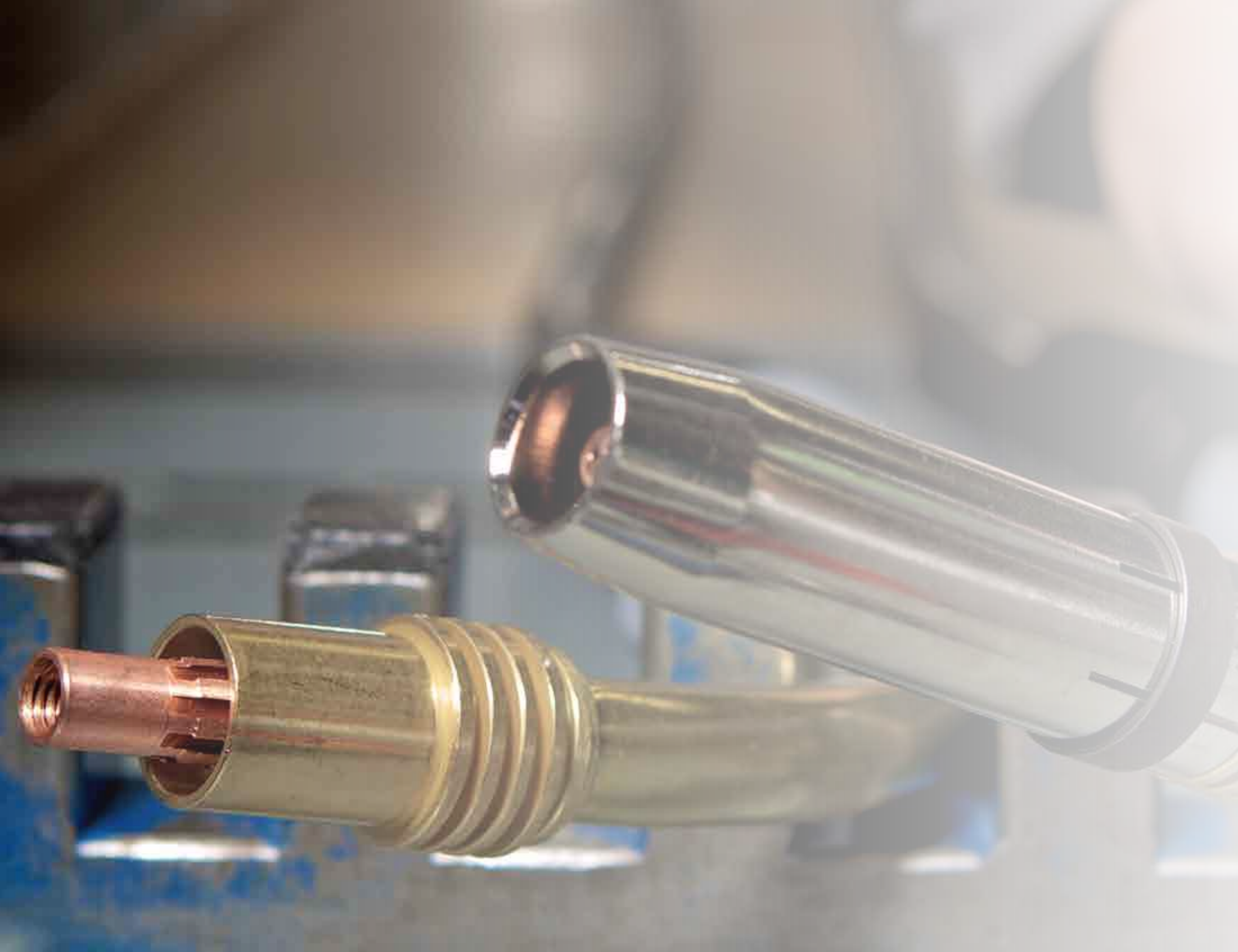

MIG TORCHES

MIG TORCHES

OPTIONS AND WEAR PARTS





MIG TORCHES WEAR PARTS

CONTACT TIPS

MIG
TORCHES



PART NUMBER	DESCRIPTION	SIZE	PACK QTY
100100	Contact tip TR-15 M6-06-0.6	6mm X 25mm	100
100102	Contact tip TR-15 M6-06-0.8	6mm X 25mm	100
100104	Contact tip TR-15 M6-06-0.9	6mm X 25mm	100
100106	Contact tip TR-15 M6-06-1.0	6mm X 25mm	100
100108	Contact tip TR-15 M6-06-1.2	6mm X 25mm	100
100122	Contact tip TR-15 M6-06-0.8A (For Alu Wire)	6mm X 25mm	100
100126	Contact tip TR-15 M6-06-1.0A (For Alu Wire)	6mm X 25mm	100
100128	Contact tip TR-15 M6-06-1.2A (For Alu Wire)	6mm X 25mm	100



PART NUMBER	DESCRIPTION	SIZE	PACK QTY
100110	Contact tip TR-15 M6-06-0.6N (Nickel Plated)	6mm X 25mm	500
100112	Contact tip TR-15 M6-06-0.8N (Nickel Plated)	6mm X 25mm	500
100116	Contact tip TR-15 M6-06-1.0N (Nickel Plated)	6mm X 25mm	500



PART NUMBER	DESCRIPTION	SIZE	PACK QTY
100200	Contact tip TR-25 M6-08-0.6	8mm X 28mm	100
100202	Contact tip TR-25 M6-08-0.8	8mm X 28mm	100
100204	Contact tip TR-25 M6-08-0.9	8mm X 28mm	100
100206	Contact tip TR-25 M6-08-1.0	8mm X 28mm	100
100208	Contact tip TR-25 M6-08-1.2	8mm X 28mm	100
100210	Contact tip TR-25 M6-08-1.4	8mm X 28mm	100
100212	Contact tip TR-25 M6-08-1.6	8mm X 28mm	100
100217	Contact tip TR-25 M6-08-0.8A (For Alu Wire)	8mm X 28mm	100
100221	Contact tip TR-25 M6-08-1.0A (For Alu Wire)	8mm X 28mm	100
100223	Contact tip TR-25 M6-08-1.2A (For Alu Wire)	8mm X 28mm	100
100227	Contact tip TR-25 M6-08-1.6A (For Alu Wire)	8mm X 28mm	100
100203	Contact tip TR-25 M6-08-0.8 CuCrZr	8mm X 28mm	100
100207	Contact tip TR-25 M6-08-1.0 CuCrZr	8mm X 28mm	100
100209	Contact tip TR-25 M6-08-1.2 CuCrZr	8mm X 28mm	100
100211	Contact tip TR-25 M6-08-1.4 CuCrZr	8mm X 28mm	100
100213	Contact tip TR-25 M6-08-1.6 CuCrZr	8mm X 28mm	100

HEAVY DUTY



MIG TORCHES WEAR PARTS

CONTACT TIPS

**MIG
TORCHES**



PART NUMBER	DESCRIPTION	SIZE	PACK QTY
100214	Contact tip TR-25 M6-08-0.6N (Nickel Plated)	8mm X 28mm	500
100216	Contact tip TR-25 M6-08-0.8N (Nickel Plated)	8mm X 28mm	500
100220	Contact tip TR-25 M6-08-1.0N (Nickel Plated)	8mm X 28mm	500
100222	Contact tip TR-25 M6-08-1.2N (Nickel Plated)	8mm X 28mm	500



PART NUMBER	DESCRIPTION	SIZE	PACK QTY
100300	Contact tip TR-401/501 M8-10-0.8	10mm X 30mm	50
1003012	Contact tip TR-401/501 M8-10-0.9	10mm X 30mm	50
100302	Contact tip TR-401/501 M8-10-1.0	10mm X 30mm	50
100304	Contact tip TR-401/501 M8-10-1.2	10mm X 30mm	50
100306	Contact tip TR-401/501 M8-10-1.4	10mm X 30mm	50
100308	Contact tip TR-401/501 M8-10-1.6	10mm X 30mm	50
100310	Contact tip TR-401/501 M8-10-2.0	10mm X 30mm	50
100312	Contact tip TR-401/501 M8-10-2.4	10mm X 30mm	50
100315	Contact tip TR-401/501 M8-10-0.8A (For Alu Wire)	10mm X 30mm	50
100317	Contact tip TR-401/501 M8-10-1.0A (For Alu Wire)	10mm X 30mm	50
100319	Contact tip TR-401/501 M8-10-1.2A (For Alu Wire)	10mm X 30mm	50
100338	Contact tip TR-401/501 M8-10-1.6A (For Alu Wire)	10mm X 30mm	50
100301	Contact tip TR-401/501 M8-10-0.8 CuCrZr	10mm X 30mm	50
100303	Contact tip TR-401/501 M8-10-1.0 CuCrZr	10mm X 30mm	50
100305	Contact tip TR-401/501 M8-10-1.2 CuCrZr	10mm X 30mm	50
100307	Contact tip TR-401/501 M8-10-1.4 CuCrZr	10mm X 30mm	50
100309	Contact tip TR-401/501 M8-10-1.6 CuCrZr	10mm X 30mm	50



PART NUMBER	DESCRIPTION	SIZE	PACK QTY
100314	Contact tip TR-401/501 M8-10-0.8N (Nickel Plated)	10mm X 30mm	500
100316	Contact tip TR-401/501 M8-10-1.2N (Nickel Plated)	10mm X 30mm	500
100318	Contact tip TR-401/501 M8-10-1.2N (Nickel Plated)	10mm X 30mm	500
100320	Contact tip TR-401/501 M8-10-1.4N (Nickel Plated)	10mm X 30mm	500

COMFORTABLE



MIG TORCHES WEAR PARTS

LINERS



BLUE LINERS



PART NUMBER	DESCRIPTION	PACK QTY
301535	Blue liner (1.5 - 4.5) 3mtr	1
301545	Blue liner (1.5 - 4.5) 4mtr	1
301555	Blue liner (1.5 - 4.5) 5mtr	1

RED LINERS



PART NUMBER	DESCRIPTION	PACK QTY
302535	Red liner (2.0 - 4.5) 3mtr	1
302545	Red liner (2.0 - 4.5) 4mtr	1
302555	Red liner (2.0 - 4.5) 5mtr	1

YELLOW LINERS



PART NUMBER	DESCRIPTION	PACK QTY
303635	Yellow liner (2.5 - 4.5) 3mtr	1
303645	Yellow liner (2.5 - 4.5) 4mtr	1
303655	Yellow liner (2.5 - 4.5) 5mtr	1

PLAIN LINERS



PART NUMBER	DESCRIPTION	PACK QTY
302530	Plain liner (2.0 - 4.0) 3mtr	1
302540	Plain liner (2.0 - 4.0) 4mtr	1
302550	Plain liner (2.0 - 4.0) 5mtr	1
304635	Plain liner (2.0 - 4.5) 3mtr	1
304645	Plain liner (2.0 - 4.5) 4mtr	1
304655	Plain liner (2.0 - 4.5) 5mtr	1
303630	Plain liner (2.5 - 4.0) 3mtr	1
303640	Plain liner (2.5 - 4.0) 4mtr	1
303650	Plain liner (2.5 - 4.0) 5mtr	1
304669	Plain liner (2.5 - 4.5) 3mtr	1
304670	Plain liner (2.5 - 4.5) 4mtr	1
304671	Plain liner (2.5 - 4.5) 5mtr	1

HEAVY DUTY



MIG TORCHES WEAR PARTS

LINERS

MIG
TORCHES

BLUE LINERS TEFLON



PART NUMBER	DESCRIPTION	PACK QTY
301538	Blue liner Teflon (1.5 - 4.0) 3mtr	1
301548	Blue liner Teflon (1.5 - 4.0) 4mtr	1
301558	Blue liner Teflon (1.5 - 4.0) 5mtr	1
304350	Blue liner Teflon (1.5 - 4.0) P/mtr	100

RED LINERS TEFLON



PART NUMBER	DESCRIPTION	PACK QTY
302538	Red liner Teflon (2.0 - 4.0) 3mtr	1
302548	Red liner Teflon (2.0 - 4.0) 4mtr	1
302558	Red liner Teflon (2.0 - 4.0) 5mtr	1
304450	Red liner Teflon (2.0 - 4.0) P/mtr	100

YELLOW LINERS TEFLON



PART NUMBER	DESCRIPTION	PACK QTY
303638	Yellow liner Teflon (2.7 - 4.7) 3mtr	1
303648	Yellow liner Teflon (2.7 - 4.7) 4mtr	1
303658	Yellow liner Teflon (2.7 - 4.7) 5mtr	1
304550	Yellow liner Teflon (2.7 - 4.7) P/mtr	100

BLACK LINERS TEFLON / GRAPHITE



PART NUMBER	DESCRIPTION	PACK QTY
304750	Black liner Teflon (2.0 - 4.0) P/mtr	100
304800	Black liner Teflon (2.7 - 4.7) P/mtr	100
304752	Black liner Graphite (2.0 - 4.0) P/mtr	200
304768	Black liner Graphite (2.3 - 4.7) P/mtr	200

COLLET + O-RING FOR TEFLON



PART NUMBER	DESCRIPTION	PACK QTY
301400	Collet for teflon liner 4.0mm	10
301401	Collet for teflon liner 4.7mm	10
301300	O-ring wire for teflon liner 4x1.5mm	25

BRASS WIRE



PART NUMBER	DESCRIPTION	PACK QTY
304820	Brass wire for graphic liner 4.0mm	10

COMFORTABLE



MIG TORCHES WEAR PARTS

NOZZLES

MIG
TORCHES



PART NUMBER	DESCRIPTION	SIZE	PACK QTY
200105	TR-15 Nozzle cylindrical	18mm X 53.5mm \varnothing 16.1mm	10
200120	TR-15 Nozzle conical	18mm X 53.5mm \varnothing 12mm	10
200145	TR-15 Nozzle tapered	18mm X 53.5mm \varnothing 10.5mm	10
200155	TR-15 Nozzle bottleneck	18mm X 53.5mm \varnothing 13mm	10



PART NUMBER	DESCRIPTION	SIZE	PACK QTY
200290	TR-24 Nozzle cylindrical	20mm X 63.5mm \varnothing 17.1mm	10
200300	TR-24 Nozzle conical	20mm X 63.5mm \varnothing 12.5mm	10
200305	TR-24 Nozzle tapered	20mm X 63.5mm \varnothing 10mm	10



PART NUMBER	DESCRIPTION	SIZE	PACK QTY
200409	TR-25 Nozzle cylindrical	22mm X 58mm \varnothing 18mm	10
200415	TR-25 Nozzle conical	22mm X 58mm \varnothing 15mm	10
200452	TR-25 Nozzle tapered	22mm X 58mm \varnothing 12mm	10
200465	TR-25 Nozzle bottleneck	22mm X 58mm \varnothing 14mm	10



PART NUMBER	DESCRIPTION	SIZE	PACK QTY
200600	TR-36 Nozzle cylindrical	24mm X 85mm \varnothing 20.1mm	10
200610	TR-36 Nozzle conical	24mm X 85mm \varnothing 16mm	10
200620	TR-36 Nozzle tapered	24mm X 85mm \varnothing 14mm	10

HEAVY DUTY



MIG TORCHES WEAR PARTS

NOZZLES

MIG
TORCHES



PART NUMBER	DESCRIPTION	SIZE	PACK QTY
200800	TR-401/501 Nozzle cylindrical	24mm X 76mm ø 20.1mm	10
200810	TR-401/501 Nozzle conical	24mm X 76mm ø 16mm	10
200830	TR-401/501 Nozzle tapered	24mm X 76mm ø 14mm	10
200840	TR-401/501 Nozzle bottleneck	24mm X 76mm ø 15.1mm	10
200805	TR-401/501 Nozzle cylindrical Heavy Duty	24mm X 76mm ø 19.1mm	10
200820	TR-401/501 Nozzle conical Heavy Duty	24mm X 76mm ø 16mm	10



PART NUMBER	DESCRIPTION	SIZE	PACK QTY
2007045	TR-450 Nozzle cylindrical	20mm X 58mm ø 14.5mm	10
2007145	TR-450 Nozzle conical	20mm X 58mm ø 14.5mm	10



PART NUMBER	DESCRIPTION	SIZE	PACK QTY
2007055	TR-550 Nozzle cylindrical	24mm X 60.5mm ø 17mm	10
2007155	TR-550 Nozzle conical	24mm X 60.5mm ø 17mm	10

COMFORTABLE



MIG TORCHES WEAR PARTS

MACHINE CONNECTIONS

MIG
TORCHES

MACHINE CONNECTIONS



PART NO.	DESCRIPTION	PACK QTY
410502	CA complete - type 502 (Guide tube L=91mm - M10x1)	1
410506	CA complete - type 506 (Guide tube L=102mm - M12x1)	1



PART NO.	DESCRIPTION	PACK QTY
2585429	Quick connector machine side with 8mm nipple	1



PART NO.	DESCRIPTION	PACK QTY
2585428	Quick connector 1/8"G male	1
2585421	Quick connector 1/4"G male	1
2585420	Quick connector 3/8"G male	1



PART NO.	DESCRIPTION	PACK QTY
2585419	Quick connector with M12x1 female nut	1
2585423	Quick connector with 1/4"G female nut	1
2585422	Quick connector with 3/8"G female nut	1

HEAVY DUTY



MIG TOOLS & ACCESSORIES

EARTH CLAMPS | CABLE CONNECTORS

MIG TORCHES

EARTH CLAMPS



PART NUMBER	DESCRIPTION	PACK QTY
430012	Earth clamp 200Amp	1



PART NUMBER	DESCRIPTION	PACK QTY
430015	Earth clamp 400Amp	1



PART NUMBER	DESCRIPTION	PACK QTY
430017	Earth clamp 600Amp	1

CABLE CONNECTIONS



PART NUMBER	DESCRIPTION	PACK QTY
305150	Cable connector plug (male) 10-25mm ²	2
305152	Cable connector plug (male) 35-50mm ²	2
305154	Cable connector plug (male) 50-70mm ²	2
305156	Cable connector plug (male) 70-95mm ²	2



PART NUMBER	DESCRIPTION	PACK QTY
305160	Cable connector plug (female) 10-25mm ²	2
305162	Cable connector plug (female) 35-50mm ²	2
305164	Cable connector plug (female) 50-70mm ²	2
305166	Cable connector plug (female) 70-95mm ²	2



PART NUMBER	DESCRIPTION	PACK QTY
305170	Panel socket (female) 10-25mm ²	2
305172	Panel socket (female) 35-50mm ²	2
305176	Panel socket (female) 70-95mm ²	2

COMFORTABLE



MIG TOOLS & ACCESSORIES

ELECTRODE HOLDERS | ANTI-SPATTER



PART NUMBER	DESCRIPTION	PACK QTY
306580	Electrode holder Economy/crocodile type 200 AMP	1
306606	Electrode holder Economy/crocodile type 400 AMP	1
306640	Electrode holder Economy/crocodile type 600 AMP	1



PART NUMBER	DESCRIPTION	PACK QTY
306600	Electrode holder Optimum type 200 AMP	1
306610	Electrode holder Optimum type 400 AMP	1
306660	Electrode holder Optimum type 600 AMP	1



PART NUMBER	DESCRIPTION	PACK QTY
306615	Electrode holder (screw) Progress type 200 AMP	1
306620	Electrode holder (screw) Progress type 400 AMP	1
306650	Electrode holder (screw) Progress type 600 AMP	1



PART NUMBER	DESCRIPTION	PACK QTY
850340	Green-Tree Safeweld (water based)	5ltr
850360	Green-Tree Safeweld (water based)	30ltr



PART NUMBER	DESCRIPTION	PACK QTY
859010	Pumpsprayer	10
859006	Aluminium can 500ml	10



PART NUMBER	DESCRIPTION	PACK QTY
320100	Worldcan - Anti-spatter spray in aerosol (300 ml)	1
320100	Worldcan ECO - Anti-spatter spray in aerosol (300 ml)	1



PART NUMBER	DESCRIPTION	PACK QTY
330100	World - Anti-spatter paste (300gram)	1

HEAVY DUTY



MIG TOOLS & ACCESSORIES

MIG PLIERS AND OTHER TOOLS

MIG TORCHES



PART NUMBER	DESCRIPTION	PACK QTY
406050	Gasflow meter	1



PART NUMBER	DESCRIPTION	PACK QTY
306890	Temperature indicator kit (200/400/800°C)	1



PART NUMBER	DESCRIPTION	PACK QTY
306810	Chipping Hammer	1



PART NUMBER	DESCRIPTION	PACK QTY
306860	Gas ignitor triplex	1



PART NUMBER	DESCRIPTION	PACK QTY
371206	MIG spanner	5



PART NUMBER	DESCRIPTION	PACK QTY
306840	Welder Chalk flat 5x13x127mm(144pieces/pack)	1



PART NUMBER	DESCRIPTION	PACK QTY
306700	MIG plier type TR-1 (12-15mm)	2
306700	MIG plier type TR-2 (15-18mm)	2

COMFORTABLE

Demo Request

Scan the QR code with your smart phone



▶ BY WELDERS. FOR WELDERS



+31 (0)30 - 604 73 73



Fahrenheitbaan 2
3439 MD Nieuwegein
The Netherlands



info@translas.com

www.translas.com

EUROPE

UNITED KINGDOM

NORTH AMERICA

